

HEREFORDSHIRE COUNCIL

**Application for a premises licence to be granted
under the Licensing Act 2003**

PLEASE READ THE FOLLOWING INSTRUCTIONS FIRST

Before completing this form please read the guidance notes at the end of the form. If you are completing this form by hand please write legibly in block capitals. In all cases ensure that your answers are inside the boxes and written in black ink. Use additional sheets if necessary.

You may wish to keep a copy of the completed form for your records.

We Hereford City Council

(Insert name(s) of applicant)

apply for a premises licence under section 17 of the Licensing Act 2003 for the premises described in Part 1 below (the premises) and I/we are making this application to you as the relevant licensing authority in accordance with section 12 of the Licensing Act 2003

Part 1 – Premises Details

Postal address of premises or, if none, ordnance survey map reference or description

High Town Hereford, pedestrianised area, starting from High Street to Commercial Street (between M&S and the bull plinth) and up St Peter's St (for toilets) to the end of the brick planter.

Post town

Hereford

Postcode

HR1 2AA

Telephone number at premises (if any)

07487 516861

Non-domestic rateable value of premises

N/A

Part 2 - Applicant Details

Please state whether you are applying for a premises licence as

Please tick as appropriate

- | | | |
|---|-------------------------------------|-----------------------------|
| a) an individual or individuals * | <input type="checkbox"/> | please complete section (A) |
| b) a person other than an individual * | | |
| i. as a limited company | <input type="checkbox"/> | please complete section (B) |
| ii. as a partnership | <input type="checkbox"/> | please complete section (B) |
| iii. as an unincorporated association or | <input type="checkbox"/> | please complete section (B) |
| iv. other (for example a statutory corporation) | <input checked="" type="checkbox"/> | please complete section (B) |

- c) a recognised club ☐ please complete section (B)
- d) a charity ☐ please complete section (B)
- e) the proprietor of an educational establishment ☐ please complete section (B)
- f) a health service body ☐ please complete section (B)
- g) a person who is registered under Part 2 of the Care Standards Act 2000 (c14) in respect of an independent hospital in Wales ☐ please complete section (B)
- ga) a person who is registered under Chapter 2 of Part 1 of the Health and Social Care Act 2008 (within the meaning of that Part) in an independent hospital in England ☐ please complete section (B)
- h) the chief officer of police of a police force in England and Wales ☐ please complete section (B)

* If you are applying as a person described in (a) or (b) please confirm:

Please tick yes

I am carrying on or proposing to carry on a business which involves the use of the premises for licensable activities; or ☒

I am making the application pursuant to a
 statutory function or ☐
 a function discharged by virtue of Her Majesty's prerogative ☐

(A) INDIVIDUAL APPLICANTS (fill in as applicable)

Mr <input type="checkbox"/>	Mrs <input type="checkbox"/>	Miss <input type="checkbox"/>	Ms <input type="checkbox"/>	Other Title (for example, Rev)	
Surname			First names		
I am 18 years old or over				<input type="checkbox"/>	Please tick yes
Current postal address if different from premises address					
Post town				Postcode	
Daytime contact telephone number					
E-mail address (optional)					

SECOND INDIVIDUAL APPLICANT (if applicable)

Mr <input type="checkbox"/>	Mrs <input type="checkbox"/>	Miss <input type="checkbox"/>	Ms <input type="checkbox"/>	Other Title (for example, Rev)	
Surname			First names		
I am 18 years old or over					<input type="checkbox"/> Please tick yes
Current postal address if different from premises address					
Post town				Postcode	
Daytime contact telephone number					
E-mail address (optional)					

(B) OTHER APPLICANTS

Please provide name and registered address of applicant in full. Where appropriate please give any registered number. In the case of a partnership or other joint venture (other than a body corporate), please give the name and address of each party concerned.

Name Hereford City Council
Address Parish Offices Town Hall St Owen Street Hereford HR1 2PJ
Registered number (where applicable)
Description of applicant (for example, partnership, company, unincorporated association etc.) Parish Council for the City of Hereford
Telephone number (if any) [REDACTED]
E-mail address (optional) [REDACTED]

Part 3 Operating Schedule

When do you want the premises licence to start?

DD		MM		YYYY			

If you wish the licence to be valid only for a limited period, when do you want it to end?

DD		MM		YYYY			

Please give a general description of the premises (please read guidance note 1)

Outdoor area of pedestrianised High Town, between High Street and Commercial Street – from outside M&S up to the bull statue plinth and up St Peter's St (for toilets) to the end of the brick planter – see site plan.

9m x 6m aluminium framed CAMRA marquee selling artisan ciders and apple juice (between two planters in front of WH Smiths) with 4.5m x 3m info tent located next to CAMRA marquee (after planter, in front of empty H Samuel unit) and 3m x 3m first aid gazebo (after next planter, in front of old Ann Summers unit) – all located at southern end of premise area.

4 no. joined 3m x 3m children and community activities' gazebos located at western end of premises area (between the bike racks in front of M&S).

8m x 6m (11m x 6m with PA wings attached) music stage at the eastern end (outside Game and Costa, in front of the bull plinth) and 2m x 2m sound tent in front of stage. 9m x 3m green room marquee attached to back of stage plus generator (between planters in front of Costa).

Portaloo toilets, including a disabled, located against the planter in St Peter's St.

Consumption of alcohol sold from CAMRA tent to be between these areas as per site plan.

If 5,000 or more people are expected to attend the premises at any one time, please state the number expected to attend.

What licensable activities do you intend to carry on from the premises?

(Please see sections 1 and 14 of the Licensing Act 2003 and Schedules 1 and 2 to the Licensing Act 2003)

Provision of regulated entertainment

Please tick any that apply

- | | |
|---|-------------------------------------|
| a) plays (if ticking yes, fill in box A) | <input type="checkbox"/> |
| b) films (if ticking yes, fill in box B) | <input type="checkbox"/> |
| c) indoor sporting events (if ticking yes, fill in box C) | <input type="checkbox"/> |
| d) boxing or wrestling entertainment (if ticking yes, fill in box D) | <input type="checkbox"/> |
| e) live music (if ticking yes, fill in box E) | <input checked="" type="checkbox"/> |
| f) recorded music (if ticking yes, fill in box F) | <input checked="" type="checkbox"/> |
| g) performances of dance (if ticking yes, fill in box G) | <input checked="" type="checkbox"/> |
| h) anything of a similar description to that falling within (e), (f) or (g) (if ticking yes, fill in box H) | <input checked="" type="checkbox"/> |

Provision of late night refreshment (if ticking yes, fill in box I) ☐

Supply of alcohol (if ticking yes, fill in box J) ☒

In all cases complete boxes K, L and M

A

Plays Standard days and timings (please read guidance note 6)			<u>Will the performance of a play take place indoors or outdoors or both – please tick</u> (please read guidance note 2)	Indoors	<input type="checkbox"/>
				Outdoors	<input type="checkbox"/>
				Both	<input type="checkbox"/>
Day	Start	Finish	<u>Please give further details here</u> (please read guidance note 3)		
Mon					
Tue					
Wed			<u>State any seasonal variations for performing plays</u> (please read guidance note 4)		
Thur					
Fri					
Sat			<u>Non standard timings. Where you intend to use the premises for the performance of plays at different times to those listed in the column on the left, please list</u> (please read guidance note 5)		
Sun					

B

Films Standard days and timings (please read guidance note 6)			<u>Will the exhibition of films take place indoors or outdoors or both – please tick</u> (please read guidance note 2)		Indoors	<input type="checkbox"/>
					Outdoors	<input type="checkbox"/>
					Both	<input type="checkbox"/>
Day	Start	Finish	<u>Please give further details here</u> (please read guidance note 3)			
Mon						
Tue						
Wed			<u>State any seasonal variations for the exhibition of films</u> (please read guidance note 4)			
Thur						
Fri						
Sat			<u>Non standard timings. Where you intend to use the premises for the exhibition of films at different times to those listed in the column on the left, please list</u> (please read guidance note 5)			
Sun						

C

Indoor sporting events Standard days and timings (please read guidance note 6)			<u>Please give further details</u> (please read guidance note 3)
Day	Start	Finish	
Mon			
Tue			<u>State any seasonal variations for indoor sporting events</u> (please read guidance note 4)
Wed			
Thur			
Fri			<u>Non standard timings. Where you intend to use the premises for indoor sporting events at different times to those listed in the column on the left, please list</u> (please read guidance note 5)
Sat			
Sun			

D

Boxing or wrestling entertainments Standard days and timings (please read guidance note 6)			<u>Will the boxing or wrestling entertainment take place indoors or outdoors or both – please tick</u> (please read guidance note 2)		Indoors	<input type="checkbox"/>
					Outdoors	<input type="checkbox"/>
					Both	<input type="checkbox"/>
Day	Start	Finish	<u>Please give further details here</u> (please read guidance note 3)			
Mon						
Tue						
Wed			<u>State any seasonal variations for boxing or wrestling entertainment</u> (please read guidance note 4)			
Thur						
Fri						
Sat			<u>Non standard timings. Where you intend to use the premises for boxing or wrestling entertainment at different times to those listed in the column on the left, please list</u> (please read guidance note 5)			
Sun						

E

Live music Standard days and timings (please read guidance note 6)			Will the performance of live music take place indoors or outdoors or both – please tick (please read guidance note 2)	Indoors	<input type="checkbox"/>
				Outdoors	<input checked="" type="checkbox"/>
				Both	<input type="checkbox"/>
Day	Start	Finish			
Mon			Please give further details here (please read guidance note 3) An 8m x 6m (11m x 6m with PA wings attached) music stage will be situated approx. between Mountain Warehouse and Santander, facing West – see attached stage specifications. Amplified live music will be played throughout the event - by local community bands and also a headline act.		
Tue					
Wed			State any seasonal variations for the performance of live music (please read guidance note 4)		
Thur					
Fri			Non standard timings. Where you intend to use the premises for the performance of live music at different times to those listed in the column on the left, please list (please read guidance note 5)		
Sat	12:00	21:00			
Sun					

F

Recorded music Standard days and timings (please read guidance note 6)			Will the playing of recorded music take place indoors or outdoors or both – please tick (please read guidance note 2)	Indoors	<input type="checkbox"/>
				Outdoors	<input checked="" type="checkbox"/>
				Both	<input type="checkbox"/>
Day	Start	Finish	Please give further details here (please read guidance note 3) Amplified background recorded music will be played between live bands and for any community dance group performances.		
Mon					
Tue					
Wed			State any seasonal variations for the playing of recorded music (please read guidance note 4)		
Thur					
Fri			Non standard timings. Where you intend to use the premises for the playing of recorded music at different times to those listed in the column on the left, please list (please read guidance note 5)		
Sat	12:00	21:00			
Sun					

G

Performances of dance Standard days and timings (please read guidance note 6)			<u>Will the performance of dance take place indoors or outdoors or both – please tick</u> (please read guidance note 2)		Indoors	<input type="checkbox"/>
					Outdoors	<input checked="" type="checkbox"/>
					Both	<input type="checkbox"/>
Day	Start	Finish	<u>Please give further details here</u> (please read guidance note 3) Any performances of dance by local community groups will take place on the stage to amplified recorded music.			
Mon						
Tue						
Wed			<u>State any seasonal variations for the performance of dance</u> (please read guidance note 4)			
Thur						
Fri						
Sat	12:00	18:00	<u>Non standard timings. Where you intend to use the premises for the performance of dance at different times to those listed in the column on the left, please list</u> (please read guidance note 5)			
Sun						

H

Anything of a similar description to that falling within (e), (f) or (g) Standard days and timings (please read guidance note 6)			Please give a description of the type of entertainment you will be providing:		
Day	Start	Finish	<u>Will this entertainment take place indoors or outdoors or both – please tick</u> (please read guidance note 2)	Indoors	<input type="checkbox"/>
Mon				Outdoors	<input type="checkbox"/>
				Both	<input type="checkbox"/>
Tue			<u>Please give further details here</u> (please read guidance note 3)		
Wed					
Thur			<u>State any seasonal variations for entertainment of a similar description to that falling within (e), (f) or (g)</u> (please read guidance note 4)		
Fri					
Sat			<u>Non standard timings. Where you intend to use the premises for the entertainment of a similar description to that falling within (e), (f) or (g) at different times to those listed in the column on the left, please list</u> (please read guidance note 5)		
Sun					

I

Late night refreshment Standard days and timings (please read guidance note 6)			Will the provision of late night refreshment take place indoors or outdoors or both – please tick (please read guidance note 2)		Indoors	<input type="checkbox"/>
					Outdoors	<input type="checkbox"/>
					Both	<input type="checkbox"/>
Day	Start	Finish	<u>Please give further details here</u> (please read guidance note 3)			
Mon						
Tue						
Wed			<u>State any seasonal variations for the provision of late night refreshment</u> (please read guidance note 4)			
Thur						
Fri						
Sat			<u>Non standard timings. Where you intend to use the premises for the provision of late night refreshment at different times, to those listed in the column on the left, please list</u> (please read guidance note 5)			
Sun						

J

Supply of alcohol Standard days and timings (please read guidance note 6)			<u>Will the supply of alcohol be for consumption – please tick</u> (please read guidance note 7)	On the premises	<input type="checkbox"/>
				Off the premises	<input type="checkbox"/>
				Both	<input checked="" type="checkbox"/>
Day	Start	Finish	<u>State any seasonal variations for the supply of alcohol</u> (please read guidance note 4) Supplied from the CAMRA tent and consumed in the premise licence area (see site plan) between 12:00 and 21:30.		
Mon					
Tue					
Wed					
Thur					
Fri					
Sat	12:00	21:00			
Sun			<u>Non standard timings. Where you intend to use the premises for the supply of alcohol at different times to those listed in the column on the left, please list</u> (please read guidance note 5)		

State the name and details of the individual whom you wish to specify on the licence as designated premises supervisor:

Name: Mark David Haslam	
<div style="background-color: black; height: 15px; width: 100%;"></div> <div style="background-color: black; height: 15px; width: 100%;"></div> <div style="background-color: black; height: 15px; width: 100%;"></div>	
Postcode	<div style="background-color: black; width: 100px; height: 15px;"></div>
Personal licence number (if known) 19/03259/PERSLI	
Issuing licensing authority (if known) Malvern Hills District Council	

K

Please highlight any adult entertainment or services, activities, other entertainment or matters ancillary to the use of the premises that may give rise to concern in respect of children (please read guidance note 8).

None

L

Hours premises are open to the public
Standard days and timings
(please read guidance note 6)

Day	Start	Finish
Mon		
Tue		
Wed		
Thur		
Fri		
Sat	12:00	21:30
Sun		

State any seasonal variations (please read guidance note 4)

Non standard timings. Where you intend the premises to be open to the public at different times from those listed in the column on the left, please list (please read guidance note 5)

M Describe the steps you intend to take to promote the four licensing objectives:

a) General – all four licensing objectives (b, c, d and e) (please read guidance note 9)

For the day of the event this licence will supersede all other licences in place. The licence will only be used for one event per year which will take place between the 20th September and 10th October. The premises licence holder must notify the licensing authority of the date of the event three months prior.

The Premises Licence Holder must notify the Licensing Authority (in writing at least 7 days before the event) of the person responsible for managing the event who must be on these licensed premises and available to the Responsible Authorities and the Licensing Authority at all times when Licensable activities are taking place.

Following consultation with the SAG, the Licensing Authority shall notify the premises licence holder in writing that the draft EMP is acceptable or unacceptable within one calendar month of receipt. Where notification is not received the draft EMP shall be deemed by the Premise Licence Holder to be agreed. The festival shall not take place until the draft Event Management Plan has been agreed by the Licensing Authority in consultation with the SAG. Once agreed no change shall be made to the draft EMP without the agreement of the Licensing Authority.

The final EMP will be submitted to the Licensing Authority and all the Safety Advisory Group at least 14 days prior to the first day of the Festival. No further changes shall take place to this document without the agreement of the SAG.

The EMP and updates must be provided to the Safety Advisory Group at the same time as they are provided to the responsible authorities and Licensing Authority. The EMP will be a working document providing details of how the Festival is to be conducted and how safety issues, identified in the event risk assessment, are to be addressed. The EMP will include an event risk assessment and provide specific details on the following areas:

- Health and Safety Responsibilities
- Venue and Site Design
- Fire Safety
- Major Incident Planning (Emergency planning)
- Communication
- Crowd Management (including steward and security numbers and their roles)
- Transport
- Management Structures
- Barriers
- Electrical Installations and Lighting
- Food and Alcohol
- Water
- Amusements,
- Attractions and Promotional displays
- Sanitary Facilities
- Waste Management
- Sound: Noise and Vibration
- Special Effects, Fireworks and Pyrotechnics
- Facilities for People with disabilities
- Medical, Ambulance and First Aid Management
- Information and Welfare
- Children - including Lost Children's Policy

The Festival must take place in accordance with the final agreed EMP produced following approval from the Licensing Authority.

b) The prevention of crime and disorder

An incident log must be kept at the premises, and made immediately available on request to an 'authorised person' (as defined by Section 13 of the Licensing Act 2003) or the Police, which must record the following:

- (a) all crimes reported to the venue
- (b) all ejections of patrons
- (c) any complaints received
- (d) any incidents of disorder
- (e) seizures of drugs or offensive weapons
- (f) any refusal of the sale of alcohol
- (g) any visit by a relevant authority or emergency service

Toughened/Polycarbonate/plastic containers shall be used at all times when the premises operate for licensable activities. All drinks shall be decanted into these containers.

A Personal licence Holder shall be on duty within the CAMRA tent at all times when the premises operate for the sale of alcohol.

All CAMRA volunteer staff engaged in the sale of alcohol to be trained by CAMRA in responsible alcohol retailing to the minimum standard of BIIAB Level 1 or any equivalent training course. No person shall be authorised to sell or supply alcohol until this training is completed. Training records shall be kept on the premises and produced to the police or an 'authorised person' (as defined by Section 13 of the Licensing Act 2003) or an authorised Trading Standards Officer of Herefordshire Council on demand.

The training shall also include:

- Drugs Awareness
- Conflict resolution
- Selling to under age person
- Selling to drunks

Such training will be recorded and records shall be kept at the premises which will be produced to an authorised officer the licensing authority or the police on demand.

Security

SIA security staff and stewards will be employed on a risk assessed basis.

The Premises Licence Holder or DPS or a person nominated by them in writing for the purpose, shall maintain a register of door supervisors which shall be kept on the premises showing the names and addresses of the door supervisors, their badge numbers. The register shall be made available on demand for inspection by Police, Licensing Authority or an authorised officer of the Security Industries Authority.

No person under the age of 18 years will be employed as stewarding personnel.

No person under the age of 21 years will be employed as SIA badged staff.

No security staff or stewards are to consume or be under the influence of alcohol or drugs whilst working. They shall be fit to carry out the duties required of them.

All security will be readily identifiable. All stewards will be readily identifiable and distinctive from security personnel.

c) Public safety

The Premises Licence Holder will appoint an Event Safety Co-ordinator who will be able to authorise and supervise safety measures.

The Event Safety Co-ordinator will be responsible for:

- Monitoring of contractors
- Liaison with contractors
- Checking of method statements and risk assessments
- Preparation and monitoring of site rules
- Safety inspections and audits – the stage and electrical contractor will provide a safety sign off certificate and a qualified electrician will sign off the temporary electrical and wiring distribution systems.
- Collection and checking of completion certificates
- Communication of safety information to contractors and employees
- Monitoring and coordinating safety performance
- Coordinating safety in response to a Major Incident
- Liaison with nominated officers from Herefordshire Council.

The name and contact details of the Event Safety Co-ordinator will be supplied via the Safety Advisory Group no later than 14 days prior to the start of the Festival.

Electrical wiring and distribution systems

Temporary electrical wiring and distribution systems shall be signed off by a competent person prior to any licensable activity taking place at the premises. The competent person must be a member of a recognised electrical association such as NICEIC, NAPIT, ECA or other association as agreed by the licensing authority. The sign off certificates shall be available for inspection by the Licensing Authority.

Any additional electrical work required after the event has commenced shall be signed off by a competent person. The competent person must be a member of a recognised electrical association such as NICEIC, NAPIT, ECA or other association as agreed by the licensing authority. The sign off certificates shall be available for inspection by the Licensing Authority.

Structures

The Premises Licence Holder will ensure that all temporary structures and any other elements of infrastructure or artistic installation have been inspected and signed off as being safe prior to the commencement of its use.

A copy of each safety sign off certificate shall be available for inspection by the Licensing Authority.

The maximum permitted numbers in each enclosed structure where regulated entertainment activities are to be provided will be submitted and agreed by the Responsible Authorities prior to the commencement of the event.

All enclosed structures that the public have entry to will have designated entry/exit points. The numbers of these entry/exit points will be determined by the occupancy capacity and will be listed in the Tent Exit Calculation document submitted in the EMP.

In this licence "enclosed structures" are classed as a structure whether tented or not, which has less than 25% of its sides open to the atmosphere (excluding entrances and exits) and which are accessible to the public when regulated entertainment is provided.

Special Effects

The installation and use of laser beams, pyrotechnics or real flames, explosive or highly flammable or smoke/foam producing agent, for any purpose shall not be permitted without prior notification to the Licensing Authority. A detailed description of the method of use, shall be made to the Licensing Authority not less than 14 days prior to the day on which the above equipment is to be used.

d) The prevention of public nuisance

Noise or vibration shall not emanate from the festival site so as to cause a nuisance. A Noise Management Strategy as approved by Herefordshire Council must be provided at least 14 days before the commencement of the event. This management strategy should include a site plan which details amplified noise direction and monitoring and management responsibilities. The premises licence holder must comply with the noise management strategy and no changes shall be made to the plan without first notifying Environmental Health.

Irrespective of noise levels prescribed in the Noise Management Strategy, The Premises Licence Holder or DPS or any person who has been nominated as their deputy must immediately comply with any request to adjust noise levels/ frequency spectra made by an 'authorised person' (as defined by Section 13 of the Licensing Act 2003).

Any testing of sound equipment will not take place before 09:00hrs and will last for no more than 2 hours on any one day.

A complaints procedure protocol will be in place so that local residents can report any noise issues directly to the HCC management. The Premises License Holder will maintain a log of noise monitoring, including any noise complaint checks and actions, which will be available at all times for inspection by Herefordshire Council and a copy provided to Herefordshire Council if requested. All calls will be logged by time, location and contact number and address will be requested.

e) The protection of children from harm**Under 16s****Disclosure barring Service (DBS) Check**

Any personnel whose role involves the looking after of children or vulnerable adults shall have a current DBS (CRB where available) (dated within the 24 month period preceding the first day of the Festival).

No person shall be involved in this role unless the DBS shows 'None Recorded' against the following categories:

- Police Record of Convictions, Cautions, Reprimands and Warning
- Information from the list held under Section 142 of the Education Act 2002
- ISA Children's Barred List Information
- ISA Vulnerable Adults Barred List Information
- Other relevant information disclosed at the Chief Police Officer(s) discretion

The name, date of birth and address together with a copy of the DBS shall be supplied to the Licensing Authority prior to the first day of the festival if requested. Records of DBS or CRB Checks will be held of all persons looking after children or vulnerable adults for examination by the licensing authority on request.

Lost Children Policy

The goal of the Lost Children Policy is to reunite each lost child with its parents or guardians. However if there is any evidence or suspicion of abuse or neglect of children, then this must be

reported to the appropriate authority.

Age Verification

The premises shall operate a Challenge 25 Policy. Such policy shall be written down and kept at the premises. The policy shall be produced on demand of the Police or an 'authorised person' (as defined by Section 13 of the Licensing Act 2003) or an authorised Trading Standards Officer of Herefordshire Council. Prominent, clear and legible signage (in not less than 32 font bold) shall also be displayed at all entrances to the premises as well as at, at least one location behind any bar area advertising the scheme operated.

In conjunction with the above condition, proof of the attainment of 25 years of age will be required through production of a PASS card, full or provisional photo card driving licence, or by a photo passport prior to any alcohol sale taking place or entry to age restricted areas.

Bar staff must ask for proof of age ID whenever the customer appears to be under 25. If there is any doubt as to the age of the customer they will be refused service.

Prominent, clear and legible signage (in not less than 32 font bold) shall be displayed stating that: It is an offence to purchase or attempt to purchase alcohol if you are under the age of 18 - Section 149 Licensing Act 2003.

A written register of refusals will be kept including a description of the people who have been unable to provide required Identification to prove their age. Such records shall be kept for a period of 12 months and will be reviewed hourly on the day of the event by the Designated Premises Supervisor and produced to the police or an 'authorised person' (as defined by Section 13 of the Licensing Act 2003) or an authorised Trading Standards Officer of Herefordshire Council on demand.

The Designated Premises Supervisor will brief bar staff that they should take reasonable steps to monitor the final destination of the drinks and where it would appear that supply is being made to a person under the age of 18 years take steps to prevent the consumption by that person.

No bar servers will be under 18.

Any underage persons who are found arriving at or on the Licensed Premises with alcohol will have the alcohol confiscated by security.

A selection of soft drinks will be available to buy, along with an ample supply of free drinking water at clearly signed locations throughout the Licensed Premises.

No adult entertainment or services or activities must take place at the premises (Adult Entertainment includes, but is not restricted to, such entertainment or services which would generally include topless bar staff, striptease, lap-table, or pole-dancing, performances involving feigned violence or horrific incidents, feigned or actual sexual acts or fetishism, or entertainment involving strong and offensive language).

Checklist:

Please tick to indicate agreement

- I have made or enclosed payment of the fee. ☒
- I have enclosed the plan of the premises. ☒
- I have sent copies of this application and the plan to responsible authorities and others where applicable. ☒
- I have enclosed the consent form completed by the individual I wish to be designated premises supervisor, if applicable. ☒

- I understand that I must now advertise my application. ☒
- I understand that if I do not comply with the above requirements my application will be rejected. ☒

IT IS AN OFFENCE, LIABLE ON SUMMARY CONVICTION TO A FINE NOT EXCEEDING LEVEL 5 ON THE STANDARD SCALE, UNDER SECTION 158 OF THE LICENSING ACT 2003, TO MAKE A FALSE STATEMENT IN OR IN CONNECTION WITH THIS APPLICATION.

Part 4 – Signatures (please read guidance note 10)

Signature of applicant or applicant's solicitor or other duly authorised agent (see guidance note 11).
If signing on behalf of the applicant, please state in what capacity.

Signature	[REDACTED]
Date	30.04.2024
Capacity	Rebecca O'Reilly, Acting Town Clerk & Proper Officer

For joint applications, signature of 2nd applicant or 2nd applicant's solicitor or other authorised agent (please read guidance note 12). **If signing on behalf of the applicant, please state in what capacity.**

Signature	
Date	
Capacity	

Contact name (where not previously given) and postal address for correspondence associated with this application (please read guidance note 13)

Post town		Postcode	
Telephone number (if any)			
If you would prefer us to correspond with you by e-mail, your e-mail address (optional)			

Notes for Guidance

1. Describe the premises, for example the type of premises, its general situation and layout and any other information which could be relevant to the licensing objectives. Where your application includes off-supplies of alcohol and you intend to provide a place for consumption of these off-supplies, you must include a description of where the place will be and its proximity to the premises.
2. Where taking place in a building or other structure please tick as appropriate (indoors may include a tent).

Consent of individual to being specified as premises supervisor

Mark David Haslam

I

[full name of prospective premises supervisor]

of



[home address of prospective premises supervisor]

hereby confirm that I give my consent to be specified as the designated premises supervisor in relation to the application for

Premises Licence

[type of application]

by

Hereford City Council

[name of applicant]

N/A

relating to a premises licence

[number of existing licence, if any]

for

Hereford AppleFest
High Town
Hereford
HR1 2AA

(pedestrianised area, starting from High Street to Commercial Street (between M&S and the bull plinth) and up St Peter's St (for toilets) to the end of the brick planter)

[name and address of premises to which the application relates]

and any premises licence to be granted or varied in respect of this application made by

Hereford City Council

[name of applicant]

concerning the supply of alcohol at

Hereford AppleFest
High Town
Hereford
HR1 2AA

[name and address of premises to which application relates]

I also confirm that I am entitled to work in the United Kingdom and am applying for, intend to apply for or currently hold a personal licence, details of which I set out below.

Personal licence number

19/03259/PERSLI

[insert personal licence number, if any]

Personal licence issuing authority

Malvern Hills District Council

[insert name and address and telephone number of personal licence issuing authority, if any]

Signed

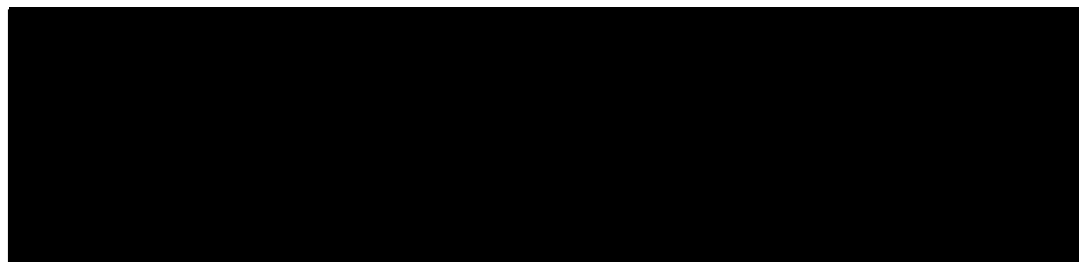
A large black rectangular box redacting the signature of the applicant.

Name (please print)

Mark David Haslam of CAMRA/ Rebecca Margaret O'Reilly
of Hereford City Council

Date

25th March 2024.

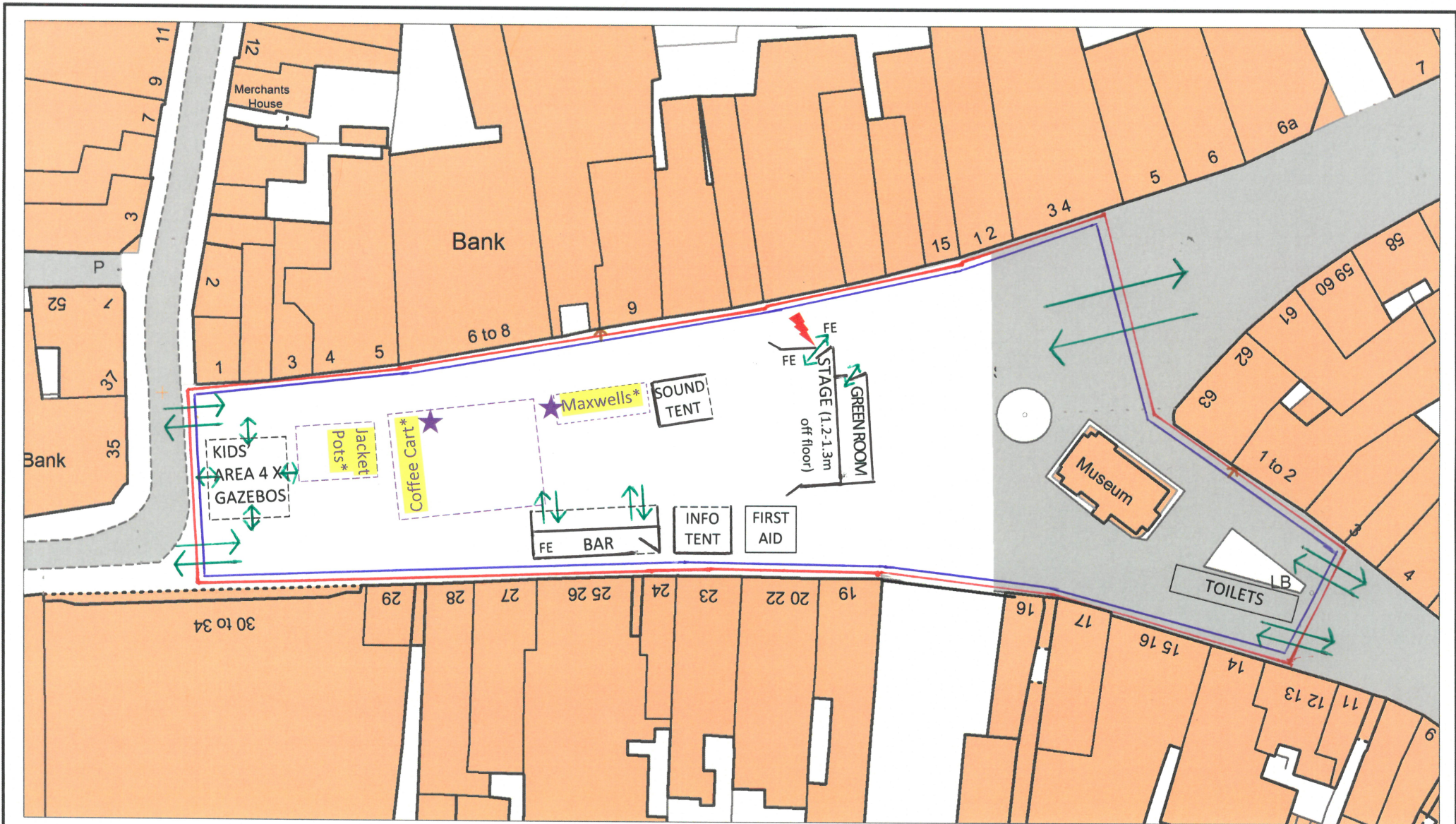

APPLEFEST SITE PLAN FOR 28 SEPTEMBER 2024 HIGH TOWN

TOILETS = 1 x Single Disabled Unit & 1 x 9-Bay Trailer

© Crown copyright and database right 2020 (100024168)

FE at = 1 x 6kg Powder Extinguisher

FE at STAGE = 1 x 6l Foam & 1 x 2kg CO² Extinguishers, 1 x Fire Blanket s

FE at BAR = 1 x 6l Water & 1 x 2kg CO² Extinguishers, 1 x Fire Blanket



= Licensable activities/boundary and sale of alcohol from bar tent

= Area alcohol to be consumed/boundary

= Regular street trader - food and soft drinks, plus minimal alcohol sales by Maxwells

= Generator

= Entry & exit points of site/premises & structures

& = Temporary structures – Bar, Stage, Kids' Activity Gazebo, Info/Event Control,

Green Room, First Aid (location of ambulance TBC), Toilets

★ = For the day of the event, this licence will supersede all other licences in place.