



TO: Hereford and Worcester County Council

STATEMENT PURSUANT TO SECTION 31, HIGHWAYS ACT 1980

I wish to deposit with Hereford and Worcester County Council the accompanying map on which the land I own is shown delineated in red.

I admit that the ways shown on the said map have been dedicated as highways.

This statement is made for the purposes of Section 31(6) of the Highways Act 1980.

Dated this 28TH day of MARCH 1994.

Signed



Received on behalf of the Hereford and Worcester County Council



Date



Environmental Services Department	
Ref No	
23 MAR 1994	
For Action	Copy for Information
MPH	
CRH	
SJW	
SJ	
JR	
TBT	
MJA	

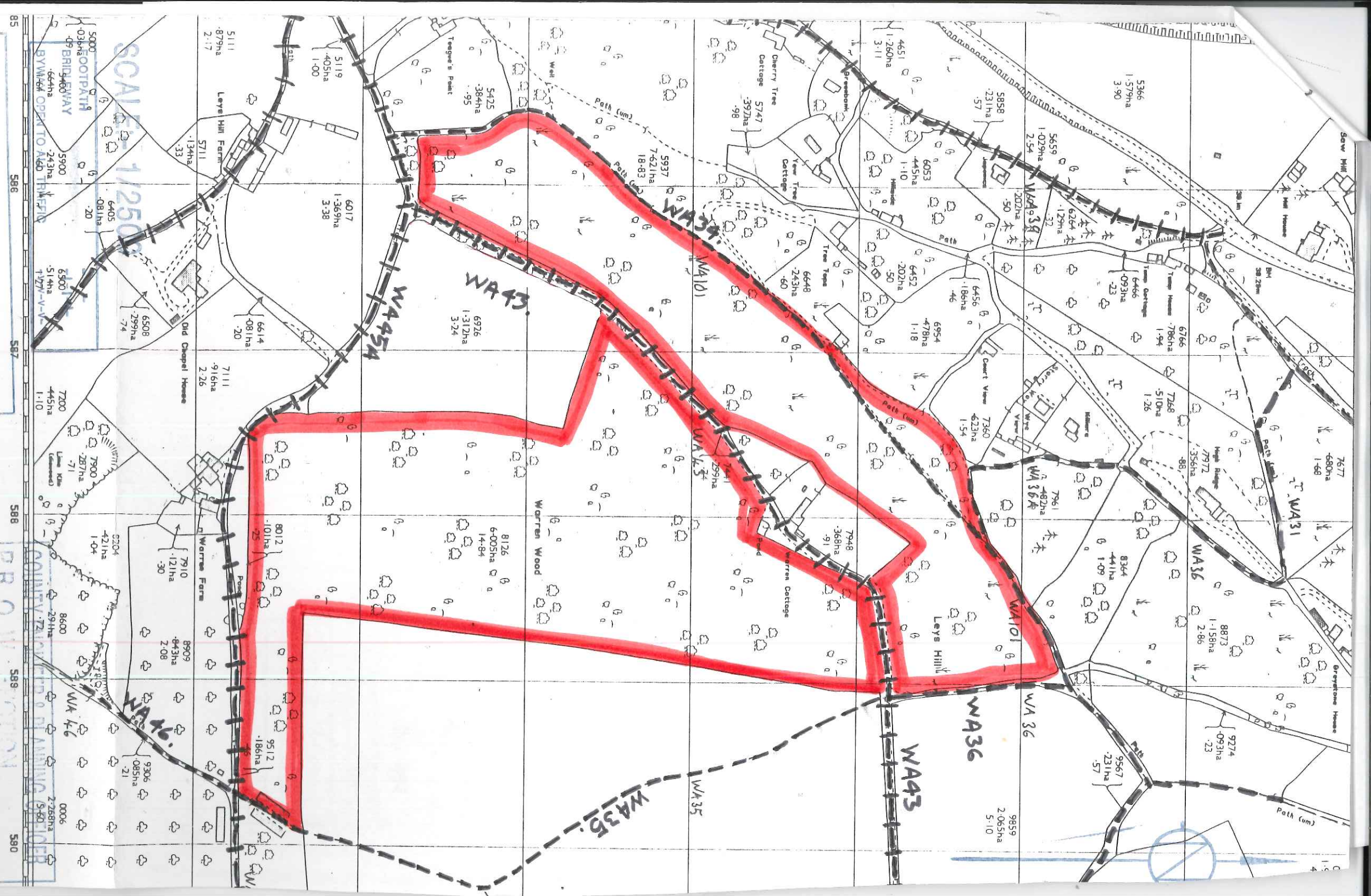

SCALES 1:2500

5000 .034ha FOOTPATH
49 BRIDGEWAY
664ha OPEN TO AERIAL TRAFFIC
5900 .243ha
6300 .514ha
7200 .445ha
7900 .287ha
8600 .29ha
0006
2.728ha
5.60

5111 .879ha
5711 .134ha
5711 .33
7111 .916ha
2.26
7910 .121ha
8909 .843ha
2.08
9512 .186ha
9306 .085ha
21

5119 .405ha
1.00
6017 .1.369ha
3.38
6614 .081ha
20
7111 .916ha
2.26
8012 .101ha
25
8126 .6.005ha
14.84
8909 .843ha
2.08
9512 .186ha

5425 .384ha
.95
5937 .7.621ha
18.83
6926 .1.312ha
3.24
8126 .6.005ha
14.84
9512 .186ha

5747 .392ha
.98
5937 .7.621ha
18.83
6648 .243ha
.60
7948 .368ha
91
9512 .186ha

4651 .1.260ha
3.11
6053 .445ha
1.10
6452 .202ha
.50
6954 .478ha
1.18
7948 .368ha
91
9512 .186ha

5858 .231ha
.57
6053 .445ha
1.10
6452 .202ha
.50
6954 .478ha
1.18
7948 .368ha
91
9512 .186ha

5659 .1.029ha
2.54
6053 .445ha
1.10
6452 .202ha
.50
6954 .478ha
1.18
7948 .368ha
91
9512 .186ha

5366 .1.579ha
3.90
6053 .445ha
1.10
6452 .202ha
.50
6954 .478ha
1.18
7948 .368ha
91
9512 .186ha

6766 .786ha
1.94
7268 .510ha
1.26
7972 .356ha
.88
8364 .441ha
1.09
8873 .1.158ha
2.86
9274 .093ha
.23
9567 .231ha
.57
9859 .2.065ha
5.10

7677 .680ha
1.68
7961 .7.482ha
17.61
8364 .441ha
1.09
8873 .1.158ha
2.86
9274 .093ha
.23
9567 .231ha
.57
9859 .2.065ha
5.10

