

NOTICE OF PROPOSAL

((VARIOUS ROADS, ROSS ON WYE) (PROHIBITION OF WAITING) (RESTRICTED WAITING) (TAXI RANK STANDS) (RESIDENTS' PARKING) (PARKING ZONES RA, RB, RC AND RD) ORDER 2005 (AMENDMENT NO.1) ORDER 2018

Notice is hereby given that the County of Herefordshire District Council, known as Herefordshire Council, in exercise of its enabling powers proposes to make the above named order under Sections 2, 4, 32(1), 35(1), 45, 46, 49 and 53 and Part IV of Schedule 9 to the Road Traffic Regulation Act 1984, the effect of which will be:

(1) to implement a no waiting, no loading and unloading at any time restriction on the south side of the B4260 Gloucester Road from a point 2.9 metres west of where the projected centre line of Smallbrook Road intersects the southern kerb line of Gloucester Road for a distance of 11.3 metres in a westerly direction, **this restriction will replace the existing on street parking bays for a distance of 11.3 metres** and is designed to improve road safety by assisting access into and out of Smallbrook Road for large vehicles and

(2) to extend the existing prohibition of waiting at any time restriction on the both sides of Ryefield Road by 10 metres to a point 17 metres north of its junction with the B4260 Gloucester Road, this is designed to improve road safety by assisting vehicles to enter and exit the junction with Gloucester Road.

A copy of the draft Order, with plan, Statement of Reasons and the Order to be amended can be viewed on the Council's website at www.herefordshire.gov.uk in the Proposed Traffic Regulation Order section. They are also available for inspection during normal office hours at the Council Offices, Plough Lane, Hereford HR4 0LE, and at the Ross-on-Wye Customer Service Centre, Ross Library, Cantilupe Road, Ross-on-Wye, HR9 7AN. Photocopies of the same may be provided on payment of photocopying charges at the Council.

General enquiries relating to the proposal should be referred to the Traffic Management Team at ADL Traffic and Highways Engineering Ltd (Tel: 01454 332100). Objections to the proposal together with the grounds on which they are made must be sent in writing to the Traffic Management Team, ADL Traffic and Highways Engineering Ltd, ADL House, Oaklands Business Park, Armstrong Way, Yate, Bristol BS37 5NA, or by email to amol@adltraffic.co.uk.

The deadline for the receipt of objections is **12:00 noon on Friday 6 July 2018**. Representations of support will also be received during this time.

Any representations received by the Council may be imparted to third parties. We will keep your data for up to 7 years. Your information may be shared with other Balfour Beatty teams within Herefordshire and Herefordshire Council in order to provide you with the service. Individuals have a number of rights under data protection law, including the right to request their information. You also have a right to make a complaint about our handling of your personal data to the Information Commissioner's Office <https://ico.org.uk/>

Richard Ball
Assistant Director Environment and Place

ROAD TRAFFIC REGULATION ACT 1984

HEREFORDSHIRE COUNCIL

((VARIOUS ROADS, ROSS ON WYE) (PROHIBITION OF WAITING) (RESTRICTED WAITING) (TAXI RANK STANDS) (RESIDENTS' PARKING) (PARKING ZONES RA, RB, RC AND RD) ORDER 2005 (AMENDMENT NO.1) ORDER 2018

The County of Herefordshire District Council, also known as Herefordshire Council, ("hereinafter called "the Council") in exercise of its powers under Sections 2, 4, 32(1), 35(1), 45, 46, 49 and 53 and Part IV of Schedule 9 to the Road Traffic Regulation Act 1984 ("the 1984 Act"), and of all other enabling powers, and after consultation with the Chief Officer of Police in accordance with Part III of Schedule 9 to the 1984 Act, hereby makes the following Order:-

Citation

1. This Order shall come into operation on the **XX** day of **XXX** 2018 and may be cited as The Herefordshire Council (Various Roads, Ross on Wye) (Prohibition of Waiting) (Restricted Waiting) (Taxi Rank Stands) (Residents Parking) (Parking Zones RA, RB, RC and RD) Order 2005 (Amendment No.1) Order 2018.
2. The prohibitions imposed by this Order shall be in addition to and not in derogation of, any restriction or requirement imposed by any regulation made or having effect as if made under the Act of 1984 by or under any other enactment.
3. The Interpretation Act 1978 shall apply for the interpretation of this order as it applies for the interpretation of an Act of Parliament.
4. The Herefordshire Council (Various Roads, Ross on Wye) (Prohibition of Waiting) (Restricted Waiting) (Taxi Rank Stands) (Residents Parking) (Parking Zones RA, RB, RC and RD) Order 2005 shall be amended in accordance with Articles 5 to 11 of this Order.
5. Article 3 shall be amended to include the following expressions together with the meanings hereby assigned to them

"Civil Enforcement Officer" means a person appointed in accordance with the provisions of Section 76 Traffic Management Act 2004

"Driver", in relation to a vehicle waiting in a Parking Place, means the person driving the vehicle at the time it was left in the parking place.
6. Articles 4 to 11 shall be amended so that the term Parking Attendant is removed and substituted with Civil Enforcement Officer.
7. Article 28 shall be amended so that the wording "The Traffic Signs and General Directions 2002 "is removed and substituted with "The Traffic Signs Regulations and General Directions 2016".

8. **Schedule 2 - No Waiting, No Loading At Any Time** shall be amended to include the following item:

B4260 Gloucester Road – South side

vi) From a point 2.9 metres west of where the projected centre line of Smallbrook Road intersects the southern kerb line of Gloucester Road for a distance of 11.3 metres in a westerly direction.

9. **Schedule 4 - No Waiting At Any Time** shall be amended to include the following item:

Ryefield Road - Both sides

i) From its junction with the B4260 Gloucester Road for a distance of 17 metres in a northerly direction.

10. **Schedule 9 - Waiting Limited to 2 hours (Mon to Sat) (9 am to 6 pm) (No return to any parking place within the same street within 2 hours) (except Parking Permit Holders as Schedule 15)** shall be amended to include the following item:

B4260 Gloucester Road – South side

i) From a point 66.8 metres east of its junction with the centre line of Chase Road to a point 14.2 metres west of where the projected centre line of Smallbrook Road intersects the southern kerb line of Gloucester Road.

11. The following provisions of The Herefordshire Council (Various Roads, Ross on Wye) (Prohibition of Waiting) (Restricted Waiting) (Taxi Rank Stands) (Residents Parking) (Parking Zones RA, RB, RC and RD) Order 2005 are hereby revoked from the date mentioned in Article 1 of this order:

Schedule 4 - No Waiting at Any Time

RYEFIELD ROAD – Both Sides

i) From its junction with B4260 Gloucester Road for a distance of 7.0 metres in a northerly direction.

Schedule 9 - Waiting Limited to 2 hours (Mon to Sat) (9 am to 6 pm) (No return to any parking place within the same street within 2 hours) (except Parking Permit Holders as Schedule 15)

B4260 GLOUCESTER ROAD - South side

i) From a point 66.8 metres east of its junction with the centre line of Chase Road to its junction with the centre line of Smallbrook Road.

12. References to any statutory provision herein shall include reference to any statutory modification substitution or re-enactment thereof.

Dated this xx Day of xxxxxxxxxxxx 2018

THE COMMON SEAL of the
COUNTY OF HEREFORDSHIRE
DISTRICT COUNCIL
was hereunto affixed **BY ORDER**

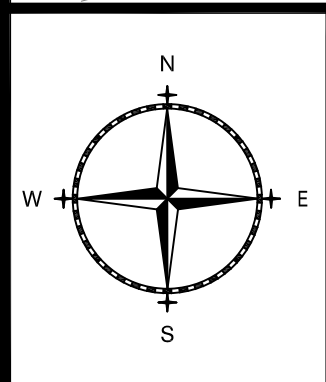
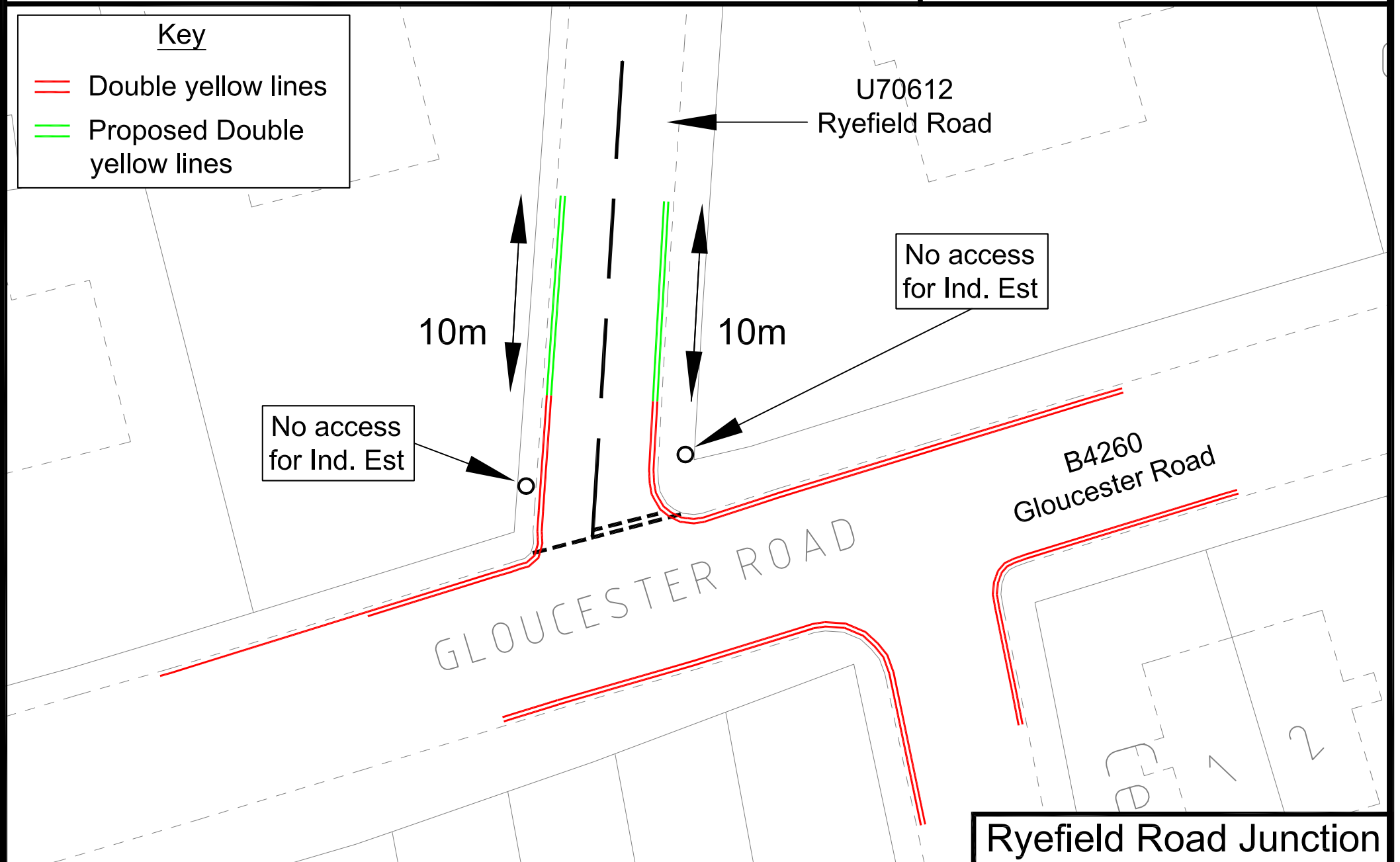
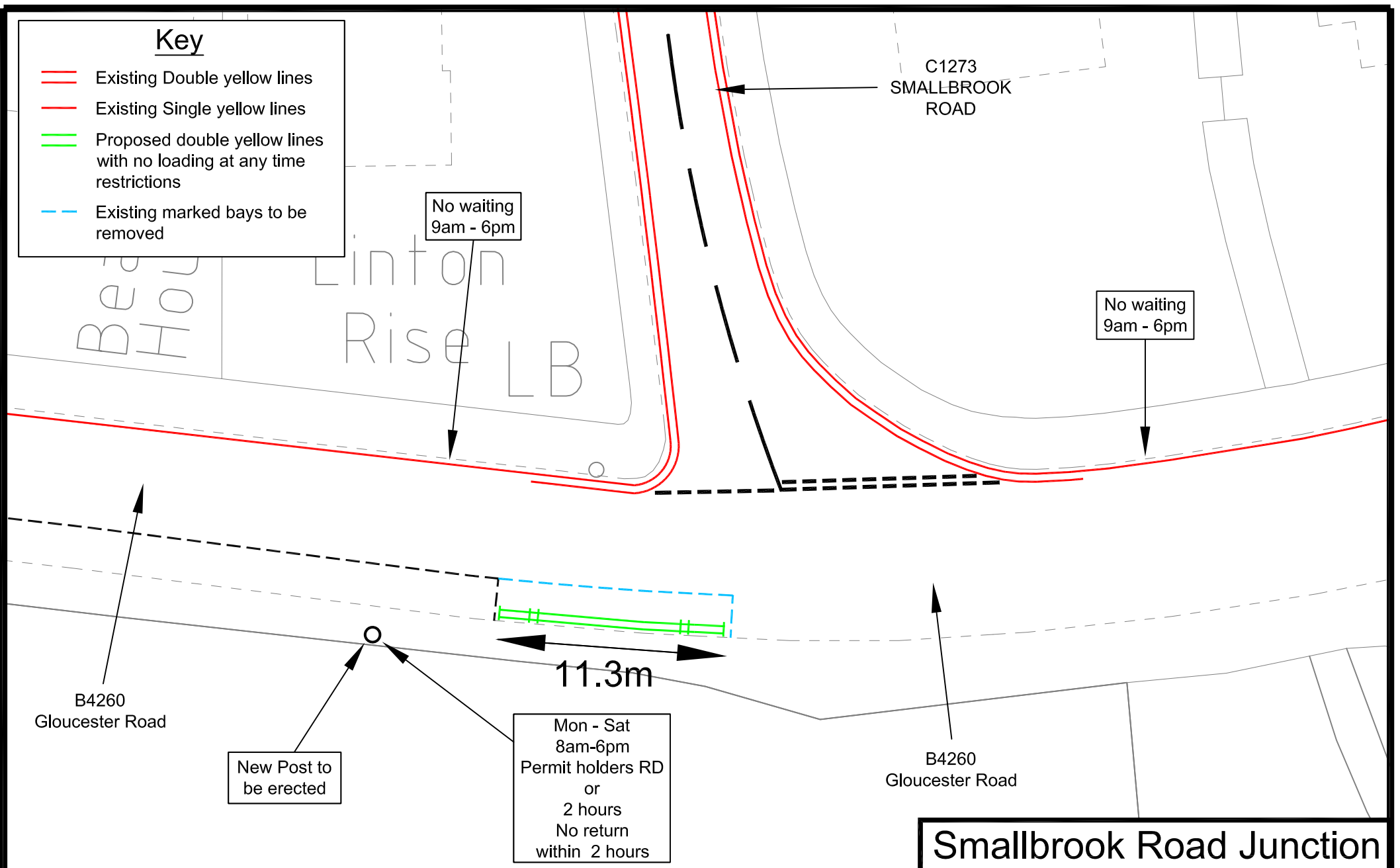

ADL
TRAFFIC & HIGHWAYS

ADL House
The Oaklands Business Park
Yate, Bristol
BS37 5NA
Tel : 01454 332100
Fax : 01454 327983
E-Mail : CAD@ADLTRAFFIC.CO.UK

NOTES

- PRELIMINARY DESIGN PROVIDED FOR ILLUSTRATIVE PURPOSES ONLY. ALL DETAILS ARE SUBJECT TO INCLUDING CHECKING STATUTORY SERVICE APPARATUS.
- DO NOT SCALE FROM THIS DRAWING.
- BACKGROUND PLAN IS BASED UPON A DIGITAL OSBASE.
- ALL DETAILS TO BE CONFIRMED ON SITE AND ON A TOPOGRAPHICAL SURVEY.
- ALL TRACKS ASSUME GRADIENTS AND CAMBERS DO NOT EXCEED 1:60 AND 1:40 RESPECTIVELY OTHERWISE VEHICLE MANOEUVRABILITY MAY BE AFFECTED.
- ALL LAND OWNERSHIP DETAILS, EXTENT OF ADOPTED HIGHWAY AND RIGHTS OF WAY TO BE CONFIRMED.
- ASSUMES ALL LANDSCAPING CAN BE ALTERED AND NO TREES ARE SUBJECT TO TPO.

Copyright ADL Traffic and Highways Engineering Ltd

AMENDMENTS		
REF.	DATE	DESCRIPTION
3409/30	30/05/18	Statutory Consultation Drawing

ADL Job No. **3409**

Project Gloucester Road Herefordshire			
Title Statutory Consultation Proposed Parking Restriction Drawing			
Date 30.05.2018	Drawn TD		
Checked	Date	Approved	Date
Scale 1:250@A3	Dwg No. 3409-30	Rev.	

HEREFORDSHIRE COUNCIL

STATEMENT OF REASONS FOR PROPOSING

((VARIOUS ROADS, ROSS ON WYE) (PROHIBITION OF WAITING) (RESTRICTED WAITING) (TAXI RANK STANDS) (RESIDENTS' PARKING) (PARKING ZONES RA, RB, RC AND RD) ORDER 2005 (AMENDMENT NO.1) ORDER 2018

The implementation of the proposed waiting, loading and unloading restrictions under Sections 2, 4, 32(1), 35(1), 45, 46, 49 and 53 and Part IV of Schedule 9 to the Road Traffic Regulation Act 1984 is necessary for the following reasons:

- To clarify the waiting, loading and unloading and parking places in the road in line with current standards and formats, and to comply with current enforcement policy,
- For the purpose of relieving or preventing congestion of traffic;
- For avoiding danger to persons or other traffic using the road or any other road or for preventing the likelihood of any such danger arising, and
- For facilitating the passage on the road or any other road of any class of traffic (*i.e. to maintain access and/or to reduce congestion*);
- For preserving or improving the amenity of the area through which the road runs.

The Council reserves the right to produce an amended or further statement in the context of any public enquiry or judicial proceedings to these proposals.

Richard Ball
Assistant Director Environment and Place

(VARIOUS ROADS, ROSS-ON-WYE)
(PROHIBITION OF WAITING) (RESTRICTED WAITING) (TAXI RANK STANDS)
(RESIDENTS PARKING) (PARKING ZONES RA, RB, RC AND RD) ORDER 2005

The County of Herefordshire District Council as statutory successors of the County of Hereford and Worcester where applicable ("the Council") in exercise of its powers under Sections 2, 4, 32(1), 35(1), 45, 46, 49 and 53 and Part IV of Schedule 9 to the Road Traffic Regulation Act 1984 ("the 1984 Act"), the Road Traffic Act 1991 (as amended) and Section 63 Local Government (Miscellaneous Provisions Act 1976 ("the 1976 Act") and of all other enabling powers, and after consultation with the Chief Officer of Police in accordance with Part III of Schedule 9 to the Act of 1984, hereby make the following Order:-

Citation

1. This Order shall come into operation on the 14th of November 2005 and may be cited as the County of Herefordshire District Council (Various Roads, Ross-on-Wye) (Prohibition of Waiting) (Restricted Waiting) (Taxi Rank Stands) (Residents Parking) (Parking Zones RA, RB, RC and RD) Order 2005.
2. Without prejudice to the validity of anything done or to any liability incurred in respect of any act or omission before the coming into operation of this Order the Orders (or parts thereof where stated) as listed in Schedule 1 hereto are hereby revoked or varied (as appropriate) from the date this Order comes into operation.
3. (1) In this Order, except where the context otherwise requires, the following expressions have the meanings hereby assigned to them:-
 - "Bridal Cars and Funeral Courtage Vehicles" means vehicles used solely in connection with weddings and funerals at Ross-on-Wye Baptist Church.
 - "Dwelling", means a house or self-contained flat registered for Council Tax purposes.
 - "Disabled Permit Holder" means a person who has been issued with a valid Disabled Person's Badge;
 - "Disabled Person's Badge" has the same meaning as in The Disabled Persons (Badges for Motor Vehicles) Regulations 2000;
 - "Disabled Person's Vehicle" means a vehicle displaying a Disabled Persons Badge and Parking Disc.
 - "Goods Vehicle" means a motor vehicle, the maximum gross weight of which exceeds 5 tonnes, which is permanently constructed or adapted for use for the carriage of goods or burden of any description and may or may not be drawing a trailer.
 - "Hackney Carriage Stand" means a stand for Hackney Carriage vehicles.
 - "Hackney Carriage Vehicle's" means a vehicle standing or plying for hire validly licenced by the Council as a Hackney Carriage and displaying an authorised plate and has the same meaning assigned to it by Section 80 of the 1976 Act applying Section 38, Town Police Clauses Act 1847.

"Light Goods Vehicle" means a motor vehicle, the maximum gross weight of which does not exceed 3.5 tonnes, which is constructed or adapted for use for the carriage of goods or burden of any description, and is not drawing a trailer.

"Motor Cycle" and "invalid carriage" have the same meaning respectively as in Section 136 of the 1984 Act.

"Multiple Occupancy Dwelling" shall mean premises where more than one family unit is in occupation.

"Owner", in relation to a vehicle, means the person by whom such vehicle is kept and used.

"Parking Attendant" means a person appointed in accordance with the provisions of Section 63A of the 1984 Act.

"Parking Disc" has the same meaning as in the Disabled Persons (Exemptions for Disabled Persons) (England) Regs. 2000.

"Parking Permit", means a permit which is designated as a Residents Parking Permit or Visitors Parking Permit issued by the Council pursuant to the provisions of this Order for either Parking Zone RA, Parking Zone RB, Parking Zone RC or Parking Zone RD;

"Parking Place", means any part of a road so marked (if any) and authorised by this Order to be used for parking.

"Parking Permit Holder", means a person to whom a Parking Permit has been issued either in Parking Zone RA Parking Zone RB Parking Zone RC or Parking Zone RD

"Parking Zone RA" means all or part (where stated) of the lengths of road for this said Zone, as stated in Schedule 15 of this Order;

"Parking Zone RB" means all or part (where stated) of lengths of road for this said Zone, as stated in Schedule 15 of this Order;

"Parking Zone RC" means all or part (where stated) of road for this said Zone, as stated in Schedule 15 of this Order;

"Parking Zone RD" means all or part (where stated) of lengths of road for this said zone as stated in Schedule 15 of this Order;

"Passenger Vehicle" means a motor vehicle (other than a Motor Cycle or invalid carriage) constructed solely for the carriage of passengers and their effects and adapted to carry not more than twelve passengers exclusive of the Driver, and not drawing a trailer.

"Public Service Vehicle" means a motor vehicle, including a tramcar or trolley vehicle, used for carrying passengers for hire or reward which either (1) is carrying passengers at separate fares: or (2) is not carrying passengers for separate fares but is adapted to carry eight or more passengers.

"Resident Parking Permit", means a permit which can only be issued to a Resident in accordance with the provisions of this Order.

"Resident RA" means a person whose main place of residence is at any of the streets (or part thereof) referred to in Schedule 15 hereto, under that heading.

"Resident RB" means a person whose main place of residence is at any of the streets (or part thereof) referred to in Schedule 15 hereto, under that heading.

"Resident RC" means a person whose main place of residence is at any of the streets (or part thereof) referred to in Schedule 15 hereto, under that heading.

"Resident RD" means a person whose main place of residence is at any of the streets (or part thereof) referred to in Schedule 15 hereto, under that heading.

"Visitors Parking Permit" means a permit which can only be issued to a Resident in accordance with the provisions of this Order.

- (2) For the purpose of this Order a vehicle shall be regarded as displaying
 - (a) a Disabled Person's Badge in the relevant position, when:-
 - (i) in the case of a vehicle fitted with a dashboard or fascia panel, the badge is exhibited thereon so that the front of the badge is legible from outside the vehicle; and
 - (ii) in the case of a vehicle not fitted with a dashboard or fascia panel, the badge is exhibited in a conspicuous position on the vehicle so that the front of the badge is legible from outside the vehicle.
 - (b) a Parking Disc in the relevant position, when:-
 - (i) in the case of a vehicle fitted with a dashboard or fascia panel, the disc is exhibited thereon so that the quarter-hour period during which the period of waiting began is legible from outside the vehicle; and
 - (ii) in the case of a vehicle not so fitted, the disc is exhibited in a conspicuous position on the vehicle so that the front of the badge is legible from outside the vehicle.
4. Save as provided in Article 21 (a) (i) (ii) and (iii) of this Order no person shall, except upon the direction or with the permission of a police officer or Parking Attendant in uniform cause or permit any vehicle to wait, load or unload at any time on those lengths of road specified in Schedule 2 to this Order and which for the purposes of identification only are shown on the attached plan.
5. Save as provided in Article 21 (a) and (c) of this Order no person shall, except upon the direction or with the permission of a police officer or Parking Attendant in uniform cause or permit any vehicle to wait at any time (or save as provided in Article 21 (a) (i) (ii) and (iii) of this Order to load and unload at the times stated in Schedule 3 herein) on those lengths of road specified in the said Schedule 3 to this Order and which for the purposes of identification only are shown on the attached plan.
6. Save as provided in Article 21 (a) and (c) of this Order no person shall, except upon the direction or with the permission of a police officer or Parking Attendant in uniform cause or permit any vehicle to wait at any time on those lengths of road specified in Schedule 4 to this Order and which for the purposes of identification only are shown on the attached plan.
7. Save as provided in Article 21 (a) and (c) of this Order no person shall, except upon the direction or with the permission of a police officer or Parking Attendant in uniform cause or permit any vehicle to wait at the times and along those lengths of road specified in Schedule 5 to this Order and which for the purposes of identification only are shown on the attached plan.

8. Save as provided in Article 21 (a) (i) (ii) (iii) (iv) and (viii) of this Order no person shall except upon the direction or with the permission of a police officer or Parking Attendant in uniform cause or permit any vehicle to wait at any time except for Disabled Persons vehicles displaying a valid Disabled Persons Badge of a Disabled Permit Holder (or Bridal Cars and Funeral Courtage Vehicles in relation to the parking place on the southwest side of B4234 Broad Street as stated in Schedule 11) at the time and on the days and on those lengths of road specified in Schedule 11 to this Order and which for the purposes of identification only are shown on the attached plan.
9. Save as provided in Article 21 (a) and (d) of this Order no person shall, except upon the direction or with the permission of a police officer or Parking Attendant in uniform cause or permit any vehicle to wait for longer than the times and on the days and on those lengths of road specified in Schedule 6 and 7 of this Order and which for the purposes of identification only are shown on the attached plan.
10. Save as provided in Article 21 (a) (b) and (d) of this Order no person shall, except upon the direction or with the permission of a police officer or Parking Attendant in uniform cause or permit any vehicle to wait, for longer than the times and on the days and on those lengths of road specified in Schedules 8, 9, and 10 of this Order and which for the purposes of identification only are shown on the attached plan.
11. Save as provided in Article 21 (a) of this Order no person shall, except upon the direction or with the permission of a police officer or Parking Attendant in uniform cause or permit any vehicle to wait at the times and on the days on those lengths of road as specified in Schedules 12 and 13 of this Order except for the purposes of loading and unloading by the types of vehicle and for the period of time as also provided in the said Schedules and for the purposes of identification only are shown on the attached plan.
12. Save as provided in Article 21 (a) (ii) the length of road as stated in Schedules 7, 13 and 14 to this Order and shown for identification purposes only are shown on the attached plan may only be used (at the times as stated in the said Schedules) as a Hackney Carriage Stand.

Power to Suspend Prohibition of Parking and Restriction of Waiting and Residents Parking

13. Nothing in Articles 4 to 12 of this Order:-
 - (a) shall restrict the power of the Council or the police for preventing obstruction of the streets, by order or otherwise on the occasion of any public procession, rejoicing or illumination, or where the streets are thronged or liable to be obstructed, to close any Parking Place; or
 - (b) shall authorise the use of any part of the road so as unreasonably to prevent access to any premises adjoining the road, or the use of the road by any person entitled to the use of thereof, or so as to be a nuisance.

Use of a Parking Place

14. A driver of a vehicle shall not use a Parking Place:-
 - (a) so as unreasonably to prevent access to any premises adjoining the road, or the use of the road by other persons entitled to do so, or so as to be a nuisance:
 - (b) when for preventing obstruction of the streets the Council shall by order or otherwise made on the occasion of any public procession, rejoicing or illumination or when the streets are thronged or liable to be obstructed have closed that Parking Place and exhibited notice of such closing on or near the Parking Place.

15. The driver of a motor vehicle using a Parking Place shall stop the engine as soon as the vehicle is in position in the Parking Place and shall not start the engine except when about to change the position of the vehicle in or to depart from the Parking Place.
16. Unless the prior written consent of the Council is obtained no person shall use a vehicle, while it is in a Parking Place in connection with the sale of any article to persons in or near the Parking Place or in connection with the selling or offering for hire of his skill or services.
17. A vehicle parked within a Parking Place must be parked wholly within the road markings (if any) for the Parking Place.
18. When a vehicle is left in a Parking Place in contravention of any of the provisions contained in paragraphs (a) or (b) of Article 14 of this Order a police constable in uniform or Parking Attendant in uniform or a person authorised in that behalf by the Council may remove the vehicle or arrange for it to be removed from that Parking Place.
19. Any person moving a vehicle by virtue of the last preceding Article of this Order may do so by towing or driving the vehicle or in such other manner as he may think necessary and may take such measures in relation to the vehicle as he may think necessary to enable him to remove it as aforesaid.
20. When a police constable or a Parking Attendant in uniform or a person authorised by the Council removes or makes arrangements for the removal of a vehicle from a Parking Place by virtue of Article 18 above of this Order, they shall make such arrangements as may be reasonably necessary for the reasonable safe custody of that vehicle.

Exemptions

21. (a) Where referred to in this Order nothing shall render it unlawful to cause or permit any vehicle to wait on the sides of those lengths of road referred to in the relevant Schedules and Articles hereto so long as may be necessary where:-
 - (i) the vehicle is waiting only for so long as is necessary to enable a person to board or alight from a vehicle;
 - (ii) the vehicle is used for fire brigade, police or ambulance purposes or a vehicle (other than a Passenger Vehicle) in the service of a local authority is being used in pursuance of statutory powers or duties;
 - (iii) the vehicle is in the service of or employed by the Post Office Company and is waiting while postal packets are being unloaded from the vehicle, or having been unloaded therefrom, are being delivered or while postal packets are being collected or is in use in connection with the servicing of telephone kiosks in the said lengths of roads;
 - (iv) the vehicle, not being a Passenger Vehicle, is waiting only for so long as may be reasonably necessary to enable it to be used for the purpose of any building operation, demolition or excavation or the maintenance, improvement or reconstruction of any said lengths of road or the laying erection, alteration, removal or repair of any sewer or of any main, pipe or apparatus for the supply of gas, water or electricity or any telegraphic line or traffic sign in any said lengths of road;
 - (v) the vehicle not being a Passenger Vehicle is in actual use in connection with the removal of furniture from one office or dwellinghouse to another or the removal of furniture from such premises to a depository or to such premises from a depository;

- (vi) the vehicle is waiting otherwise than in a parking space if goods are being sold or offered for sale from the vehicle by a person who is licensed by a local authority to sell goods from a stationary pitch situated in any said lengths of road;
 - (vii) the vehicle is waiting only for so long as is necessary to enable it to be used in connection with posting or removing advertising material in the form of posters on or from, or cleaning windows or chimneys in, premises adjacent to any said lengths of road in which the vehicle is waiting; or
 - (viii) in any other case the vehicle is waiting for the purpose of delivering or collecting goods or merchandise, including, so far as a Bank is concerned, cash or other valuables or valuable securities, or
- (b) Without prejudice to the foregoing provisions of this Order with respect to vehicles left in a Parking Place in accordance with those provisions, a vehicle may wait without limitation on any of the lengths of road described in the relevant Schedules 8, 9 and 10 to this Order if the vehicle displays a valid Parking Permit issued by the Council and is left in a Parking Place in Parking Zone RA Parking Zone RB Parking Zone RC or Parking Zone RD as appropriate.
 - (c) Nothing in Articles 5 6 and 7 of this Order shall render it unlawful to cause or permit a Disabled Person's Vehicle which displays in the relevant position a Disabled Person's Badge, and a Parking Disc (on which vehicle has been marked the time at which the period of waiting began) to wait in the said sides of those lengths of road referred to in Schedules 3 (in accordance with the provisions of Article 5), 4 and 5 hereto for a period not exceeding three hours (not being a period separated by an interval of less than one hour from a previous period of waiting by the same vehicle on the same sides of length of road on the same day).
 - (d) Nothing in Article 10 of this Order shall render it unlawful to cause or permit a Disabled Person's Vehicle which displays in the relevant position a Disabled Person's Badge, and a Parking Disc (on which the vehicle has been marked the time at which the period of waiting began) to wait in the said sides of those lengths of road referred to in Schedules 6, 7, 8, 9 and 10 hereto without limitation.

Charge and Display in connection with the use of Parking Permits

22. (1) There will be a charge of £25 per annum for the issue of each Parking Permit subject to Article 23(5) below.
- (2) Subject to the provisions of this Order the said charge in connection with the use of a Parking Permit issued for the leaving of a vehicle in a Parking Place shall be payable and shall be indicated by the issue of a Parking Permit and by the affixing of the Parking Permit in the manner prescribed in paragraph (4) of this Article not later than on the first leaving of a vehicle in a Parking Place.
- (3) A Parking Permit which is a Residents Parking Permit may only be affixed to the vehicle to which it relates.
- (4) The manner in which a Parking Permit shall be affixed to the vehicle shall be as follows:-

A Parking Permit shall be affixed to the front windscreen of the vehicle so that all particulars of the Parking Permit referred to in Article 26 of this Order are clearly visible when viewed from the front of the vehicle.

Application for and Issue of Parking Permits

23. (1) Every Dwelling within a street (or part thereof) as listed in Schedule 15 hereto may be issued with a maximum of two Parking Permits (namely one Residents Parking Permit and one Visitors Parking Permit) for the relevant Parking Zone RA Parking Zone RB Parking Zone RC or Parking Zone RD and an applicant occupier of a Dwelling shall make an application on a form issued by and obtainable from the Council and shall include the particulars and information required by such form to be supplied and the said Parking Permits are only available in respect of vehicles of the following class, that is to say a Passenger Vehicle, a Light Goods Vehicle or a Motor Cycle.
- (2) A Parking Permit which is designated as a Residents Parking Permit may only be issued to the Owner of a vehicle who occupies a Dwelling as stated in the above paragraph (1) of this Article.
- (3) A Parking Permit that is designated as a Visitors Parking Permit may only be issued to a Resident RA Resident RB Resident RC or Resident RD if the Council is satisfied that there is sufficient capacity within the Parking Place of the appropriate Parking Zone RA Parking Zone RB Parking Zone RC or Parking Zone RD.
- (4) Where a dwelling is a Multiple Occupancy Dwelling the same number of permits will be issued to that dwelling as stated in sub clause (1) of this Article.
- (5) The Council are at liberty to vary the policy charges and terms for the issue of a Parking Permit as stated in this Article on giving the Parking Permit Holder prior written notice of any said variation (where appropriate) and to also issue a Parking Permit for a parking place to an applicant who does not reside in either Parking Zone RA, Parking Zone RB, Parking Zone RC or Parking Zone RD.
- (6) The Council may at any time require an applicant for a relevant Parking Permit or any relevant Parking Permit Holder to produce to an officer of the Council such evidence in respect of an application for a Parking Permit made to them as they may reasonably call for to verify any particulars or information given to them or in respect of an application for a Parking Permit made to them as they may reasonably call for to verify that the Parking Permit is valid.
- (7) On receipt of an application duly made under the foregoing provisions of this Article the Council, upon being satisfied that the applicant is a Resident RA Resident RB Resident RC or Resident RD and is the Owner of a vehicle of the class specified in paragraph (1) of this Article, it shall issue to the applicant a Parking Permit.

Surrender, Withdrawal and Validity of Parking Permits

24. (1) A Parking Permit Holder may surrender a Parking Permit to the Council at any time and shall surrender a Parking Permit to the Council on the occurrence of any one of the events set out in paragraph (3) of this Article.
- (2) The Council may by notice in writing served on the Parking Permit Holder by sending the same by recorded delivery service to the Parking Permit Holder at the address shown by that person on the application for the Parking Permit or at any other address believed to be that person's place of abode, withdraw a Parking Permit if it appears to the Council that any one of the events set out in paragraphs (3)(a), (3)(b), (3)(d) or (3)(e) of this Article has occurred and the Parking Permit Holder shall surrender the Parking Permit to the Council within 48 hours of the receipt of the aforementioned notice or if the Parking Permit Holder fails to do so within this time the Parking Permit shall cease to have effect.
- (3) The events referred to in the foregoing provisions of this Article are:-

- (a) the Parking Permit Holder ceasing to be a Resident of a dwelling listed in the streets in Schedule 15 hereto.
 - (b) in respect of a Parking Permit which is designated as a Resident Parking Permit the Parking Permit Holder ceasing to be the Owner of the vehicle in respect of which the Parking Permit was used;
 - (c) the withdrawal of the Parking Permit by the Council under the provisions of paragraph (2) of this Article;
 - (d) the vehicle in respect of which a Parking Permit was issued being adapted or used in such a manner that it is not a vehicle of the class specified in Article 19(1) of this Order;
 - (e) the issue of a duplicate Parking Permit by the Council under the provisions of Article 25 of this Order.
- (4) Without prejudice to the foregoing provisions of this Article, a Parking Permit shall cease to be valid at the expiration of the month and year specified thereon or on the occurrence of any one of the events set out in paragraph 3 of this Article, whichever is the earlier.

Application for and issue of Duplicate Parking Permits

25. (1) if a Parking Permit is mutilated or torn or the figures or particulars thereon have become illegible the Parking Permit Holder shall either surrender it to the Council or apply to the Council for the issue to him of a duplicate Parking Permit and the Council upon the receipt of the Parking Permit, shall issue a duplicate Parking Permit so marked and upon such issue the previous Parking Permit shall become invalid.
- (2) if a Parking Permit is lost or destroyed the Parking Permit Holder may apply to the Council for the issue to him of a duplicate Parking Permit and the Council, upon being satisfied as to such loss or destruction, shall subject to paragraph (4) of this Article issue a duplicate Parking Permit so marked and upon such issue the Parking Permit shall become invalid.
- (3) the provisions of this Order shall apply to a duplicate Parking Permit or application in respect thereof as if it were a Parking Permit or as the case may be an application in respect thereof.
- (4) a charge of £10.00 will be payable by the Parking Permit Holder to the Council for the issuing of a duplicate Parking Permit.

Form of Parking Permits

26. A Parking Permit shall be in writing and shall include the following particulars:-
- (a) in respect of a Parking Permit which is designated as a Residents Parking Permit the registration mark of the vehicle in respect of which the Parking Permit was issued;
 - (b) the month and year up to which, subject to the provisions of Articles 22 (3) and (4) of this Order, the relevant Parking Permit shall remain valid;
 - (c) an indication that the Parking Permit was issued by the Council.

Restriction on Removal of Parking Permits

27. Where a Parking Permit has been displayed on a vehicle in accordance with the provisions of Article 22 (4) of this Order, no person, not being the driver of the vehicle, shall remove the Parking Permit from the vehicle unless authorised to do so by the driver of that vehicle.

Placing of Traffic Signs

28. The Council shall:-
- (a) cause the limits of each Parking Place to be indicated on the carriageway by placing and maintaining thereon traffic signs of any size, colour and type prescribed in The Traffic Signs and General Directions 2002: and
 - (b) carry out such other work as is reasonably required for the purposes of the satisfactory operation of a Parking Place.

Miscellaneous

29. References to any statutory provision herein shall include reference to any statutory modification or re-enactment thereof.

Dated this November 2005

**THE COMMON SEAL of
THE COUNTY OF HEREFORDSHIRE
DISTRICT COUNCIL** was hereunto
affixed **BY ORDER**

..... Authorised Officer

SCHEDULE 1

Existing Orders to be Revoked or Varied or Revoked in Part (as stated)

County of Herefordshire District Council (Cantilupe Road, Ross-on-Wye) (Prohibition of Waiting) (Restricted Waiting) (Residents Parking) (Experimental) Order 2004 - (varied as stated below)

Article 3 (1) "Resident" to be replaced by the provisions set out as Resident RD of the (Various Roads, Ross-On-Wye) (Prohibition Of Waiting) (Restricted Waiting) (Taxi Rank Stands) (Residents Parking) (Parking Zones RA, RB, RC And RD) Order 2005

Article 17 to be replaced by the provisions set out in Article 22 of the said 2005 Order

Article 18 to be replaced by the provisions set out in Article 23 of the said 2005 Order

Article 19 (5) to be varied to read "A Parking Permit shall be valid in Parking Zone RD as set out in the provisions of the said 2005 Order.

Article 20 (4) to be replaced by the provisions set out in Article 24 (4) of the said 2005 Order.

Schedule 4 to be varied to read "Waiting limited to 2 hours (Mon to Sat)(9am to 6pm,) (no return to any parking place in the same road within 2 hours) (except Parking Permit Holders or Parking Zone RD) of the said 2005 Order.

The County of Herefordshire District Council (Hill Street, Ross-on-Wye) (Prohibition of Waiting) (Restriction of Waiting) (Residents Parking) Order 2002 - (revoked)

Article 3 (1) "Resident" to be replaced by the provisions set out as Resident RD of the (Various Roads, Ross-On-Wye) (Prohibition Of Waiting) (Restricted Waiting) (Taxi Rank Stands) (Residents Parking) (Parking Zones RA, RB, RC And RD) Order 2005

Article 15 to be replaced by the provisions set out in Article 21 of the said 2005 Order

Article 16 to be replaced by the provisions set out in Article 22 of the said 2005 Order

Article 18 (4) to be replaced by the provisions set out in Article 24 (4) the said 2005 Order

Schedule 2 to be varied to read "Waiting limited to 30 minutes (Mon to Sat)(8am to 6pm,) (no return to any parking place in the same road within 1 hour) except Parking Permit Holders for Parking Zone RD of the said 2005 Order.

The Herefordshire County Council (Various Roads, Ross-on-Wye) (Consolidation and Amendment of Waiting Restrictions) Order 1972 (revoked in part as stated below)

Schedule 3 items 1, 2, 4 to 6, 8, 11 to 14, 16

Schedule 4

Schedule 5 item 2,

Schedule 6 items 1 and 2

Schedule 7 items 1 and 2

(Various Roads, Ross-on-Wye) (Prohibition and Restriction of Waiting and Restriction of Loading and Unloading) Order 1993 (revoked in part as stated below)

Schedule 1 Items 3, 4, 5, 7, 8, 11, 12

Schedule 2

Schedule 3

Schedule 4 Item 2

The County of Hereford and Worcester (Broad Street, Ross-on-Wye) (Street Parking Places) Order 1997 - (revoked)

The County of Herefordshire District Council, Gloucester Road, Ross-on-Wye (Street Parking Places) Order 1997 - (revoked)

The County of Hereford and Worcester (Broad Street, Ross-on-Wye) (Prohibition of Waiting, Loading and Unloading) Order 1997- (revoked)

The County of Hereford and Worcester (Various Roads, Ross-on-Wye) (Prohibition of and Restriction Waiting and Restriction of Loading and Unloading) Order 1996 - (revoked in part as stated below)

Schedule 1 Items 2 3 4 5 and 6
Schedule 2 Items 1 to 4

The County of Herefordshire District Council, Gloucester Road, Ross-on-Wye (Prohibition of Waiting, Loading and Unloading) Order 1999- (revoked)

B4260 Wilton Road, Ross-on-Wye (Street Parking Places, Loading and Unloading) (Variation) Order 1999- (revoked)

The County of Herefordshire District Council, Gloucester Road, Ross-on-Wye (Prohibition and Restriction of Waiting) (Amendment) Order 1999- (revoked)

The County of Herefordshire District Council, Various Roads, Ross-on-Wye (Street Parking Places) (Amendment No. 1) Order 1999 - (revoked in part as stated below)

Schedule 1 Items 13, 15 and 16
Schedule 2 (residents parking permits)

The County of Herefordshire District Council (Various Roads, Ross-on-Wye) (Consolidation and Amendment of Waiting Restrictions) (Amendment) Order 1999 - (revoked in part as stated below)

Article 1b

The County of Hereford and Worcester (Various Traffic Regulation Orders, Ross-on-Wye) (Variation) Order 1996- (revoked in part as stated below)

Every part of order except Article 1 (a) (iv) Brookend Street

The County of Hereford and Worcester (Various Roads, Ross-on-Wye) (Street Parking Places) Order 1996 - (revoked in part as stated below)

Schedule 1 items 3, 4, 5, 6, 7, 8, 10
Schedule 2 (residents parking permits)

The Herefordshire County Council (Church Street, Ross-on-Wye) (Prohibition of Waiting) Order 1967- (revoked)

The Trunk Road (Gloucester Road, Ross-on-Wye) (Prohibition and Restriction of Waiting) Order 1971- (revoked)

The County of Hereford and Worcester (Old Gloucester Road and Overross Street, Ross-on-Wye) (Prohibition of Waiting) Order 1979 - (revoked in part as stated below)
Item 1 of the Schedule

The County Of Hereford (Ross-On-Wye) (Traffic Regulation) Order 1952 - (revoked)

The County of Hereford and Worcester (Ashburton Industrial Estate Road and Station Approach, Ross-on-Wye) (Prohibition of Waiting) Order 1984 - (revoked)

The County of Hereford and Worcester (Wilton Road, Ross-on-Wye) (Prohibition of Waiting) Order 1990- (revoked)

The Hereford and Worcester (Trenchard Street and Greytrees Road, Ross-on-Wye) (Prohibition of Waiting) Order 1983- (revoked in part as stated below)

That part of the Schedule relating to Trenchard Street

SCHEDULE 2

No Waiting, No Loading At Any Time.

B4234 BROAD STREET – Both sides

- ✓ i) ✓ From its junction with the southern kerblines of Kyrle Street for a distance of 18.5 metres in a southwesterly direction.
- ii) ✓ From a point 64.3 metres southwest of its junction with the southern kerblines of Kyrle Street to a point 69.4 metres southwest of that junction.

B4234 BROAD STREET – Southeast side

- ✓ i) ✓ From a point 100.6 metres southwest of its junction with the southern kerblines of Kyrle Street to a point 35.0 metres southwest of its junction with the tangent point of the southwestern kerblines of New Street and western kerblines of Broad Street.

B4234 BROAD STREET – Northwest side

- ✓ i) ✓ From a point 105.9 metres southwest of its junction with the southern kerblines of Kyrle Street to a point 24.0 metres south of its junction with the tangent point of the southern kerblines of New Street and western kerblines of Broad Street.

B4260 GLOUCESTER ROAD – North side

- i) ✓ From its junction with the tangent point of the eastern kerblines of Cantilupe Road for a distance of 50 metres in an easterly direction.
- ii) ✓ From its junction with the tangent point of the western kerblines of Cantilupe Road and Henry Street for a distance of 10.7 metres in a westerly direction.
- iii) ✓ From a point 31.6 metres west of its junction with the tangent point of the western kerblines of Cantilupe Road and Henry Street to a point 42.0 metres west of that junction.
- iv) ✓ From a point 73.0 metres west of its junction with the tangent point of the western kerblines of Cantilupe Road and Henry Street to its junction with the tangent point of the eastern kerblines of Hill Street.
- v) ✓ From its junction with the tangent point of the western kerblines of Hill Street for a distance of 26.5 metres in a westerly direction.
- vi) ✓ From a point 36.8 metres west of its junction with the tangent point of the western kerblines of Hill Street to a point 42.6 metres west of that junction.
- vii) ✓ From a point 54.6 metres west of its junction with the tangent point of the western kerblines of Hill Street to its junction with Market Place and High Street.

B4260 GLOUCESTER ROAD – South side

- i) ✓ From a point 46.3 metres west of its junction with the centre line of Chase Road to a point 68.0 metres west of that junction.
- ii) ✓ From a point 89.0 metres west of its junction with the centre line of Chase Road to a point 96.0 metres west of that junction.
- iii) ✓ From a point 130.0 metres west of its junction with the centre line of Chase Road to a point 136.6 metres west of that junction.
- iv) ✓ From a point 157.3 metres west of its junction with the centre line of Chase Road to a point 169.3 metres west of that junction.
- v) ✓ From a point 206.0 metres west of its junction with the centre line of Chase Road to its junction with High Street.

B4234 MARKET PLACE – West side

- i) / From a point 67.7 metres south of the tangent point of the southwestern kerbline of New Street and western kerbline of Broad Street to its junction with High Street.

B4234 MARKET PLACE – East side

- i) / From a point 61.6 metres south of its junction with the tangent point of the southwestern kerbline of New Street and western kerbline of Broad Street to its junction with Gloucester Road.

SCHEDULE 3

No Waiting At Any Time, No Loading Mon to Sat 8am to 9.30am, 4.30pm to 6pm.

CHURCH STREET – Both sides

- i) / From its junction with the southern kerbline of High Street for a distance of 5.1 metres in a southerly direction.

B4234 and B4260 HIGH STREET – West, South and Southwest sides

- i) / For its entire length from its junction with Copse Cross Street and Old Gloucester Road to its junction with Edde Cross Street.

B4234 and B4260 HIGH STREET – East and North sides

- i) / From its junction with Copse Cross Street and Old Gloucester Road to a point 35.5 metres east of the eastern kerbline of Church Street.
- ii) / From a point 10.5 metres east of the eastern kerbline of Church Street to its junction with Edde Cross Street.

ST. MARY'S STREET – Northwest side

- i) / From its junction with the southern kerbline of High Street a point 31.9 metres southwest of that junction.

ST. MARY'S STREET – Southeast side

- i) / From its entire length from its junction with the southern kerbline of High Street to its junction with Royal Parade.

SCHEDULE 4

No Waiting At Any Time.

ALTON STREET – South side

- i) From its junction with the centre line of Merrivale Lane for a distance of 15 metres in an easterly direction.
- ii) From its junction with the centre line of Merrivale Lane for a distance of 14 metres in a westerly direction.

ASHBURTON INDUSTRIAL ESTATE ROAD and STATION APPROACH

– Both sides

- i) / For its entire length from its junction with Station Street and Smallbrook Road to its junction with Gloucester Road.

B4234 BROAD STREET – Both sides

- ✓ i) / From its junction with Brookend Street to its junction with the southern kerbline of Kyrle Street.

CAMP ROAD – Both sides

- i) / From its junction with Gloucester Road for a distance of 7.0 metres in a southerly direction.

CHURCH STREET – West side

- i) From a point 5.1 metres south of its junction with the southern kerbline of High Street to a point 59.0 metres south of that junction.
- ii) From a point 111.2 metres south of its junction with the southern kerbline of High Street to a point 135.0 metres south of that junction.
- iii) From a point 141.4 metres south of its junction with the southern kerbline of High Street to a point 148.5 metres south of that junction.

CHURCH STREET – East side

- i) From a point 5.1 metres south of its junction with the southern kerbline of High Street for its entire length to its junction with Old Maid's Walk.

CHURCH STREET and OLD MAID'S WALK – Northwest side

- i) From a point 200.0 metres south of its junction with the southern kerbline of High Street to the entrance to Crossfields car-park and the limit of adopted highway.

EDDE CROSS STREET – West side

- i) For its entire length from its junction with Wilton Road and Wye Street to its junction with Trenchard Street.

EDDE CROSS STREET – East side

- i) From its junction with High Street to a point 59.7 metres south of its junction with the tangent point of the southern kerbline of New Street.
- ii) From its junction with the tangent point of the southern kerbline of New Street to a point 19.0 metres south of that junction.
- iii) From its junction with the tangent point of the northern kerbline of New Street to a point 13.5 metres north of that junction.
- iv) From a point 32.3 metres north of its junction with the tangent point of the northern kerbline of New Street to a point 53.2 metres north of that junction.
- v) From a point 69.7 metres north of its junction with the tangent point of the northern kerbline of New Street to its junction with the tangent point of the southern kerbline of Kyrle Street.

B4260 GLOUCESTER ROAD – North side

- i) From its junction with the tangent point of the eastern kerbline of Ryefield Road for a distance of 25.0 metres in an easterly direction.
- ii) From its junction with the tangent point of the western kerbline of Ryefield Road for a distance of 10.0 metres in a westerly direction.
- iii) From its junction with the tangent point of the eastern kerbline of Smallbrook Road for a distance of 10.0 metres in an easterly direction.
- iv) From its junction with the tangent point of the western kerbline of Smallbrook Road for a distance of 10.0 metres in a westerly direction.

B4260 GLOUCESTER ROAD – South side

- i) From its junction with the tangent point of the eastern kerbline of Camp Road for a distance of 10.0 metres in an easterly direction
- ii) From its junction with the tangent point of the western kerbline of Camp Road for a distance of 18 metres in a westerly direction.
- iii) From its junction with the centre line of Chase Road to a point 66.8 metres east of that junction.
- iv) From its junction with the centre line of Chase Road to a point 22.5 metres west of that junction.

HENRY STREET – East side

- i) From a point 165.7 metres south of its junction with Station Street to its junction with Cantilupe Road.
- ii) From a point 100.5 metres south of its junction with Station Street to a point 112.0 metres south of that junction.
- iii) From its junction with Station Street to a point 44.0 metres south of that junction.

HENRY STREET – West side

- i) For its entire length from its junction with Station Street to its junction Gloucester Road.

KYRLE STREET – North side

- i) For its entire length from its junction with Edde Cross Street to its junction with Broad Street

KYRLE STREET – South side

- i) From its junction with Edde Cross Street to a point 15.5 metres east of that junction.
- ii) From a point 67.0 metres east of its junction with Edde Cross Street to its junction with Broad Street.

MERRIVALE LANE – Both sides

- i) From its junction with Alton Street for a distance of 15 metres in a southerly direction.

OLD GLOUCESTER ROAD – North side

- i) From its junction with Copse Cross Street and High Street to a point 115.5 metres east of that junction. ? 105.5
- ii) From its junction with Chase Road to a point 39.0 metres west of that junction.

OLD GLOUCESTER ROAD – South side

- i) From its junction with Copse Cross Street and High Street to a point 115.5 metres east of that junction. 105.5
- ii) From its junction with Chase Road to a point 89.0 metres west of that junction.

OLD MAID'S WALK – North side

- i) For its entire length from its junction with Church Street to its junction with B4234 Copse Cross Street.

OLD MAID'S WALK – South side

- i) From its junction with Walford Road for a distance of 15 metres in a westerly direction.
- ii) From a point 26.5 metres west of its junction with Walford Road to a point 41 metres west of that junction.
- iii) From a point 53.5 metres west of its junction with Walford Road to a point 63.8 metres west of that junction.
- iv) From a point 109.0 metres west of its junction with Walford Road to its junction with Church Street.

ROYAL PARADE – Northwest and north sides

- i) From its junction with the B4260 Wilton Road to a point 20.1 metres northeast of that junction.
- ii) From a point 80.0 metres northeast of its junction with Wilton Road to a point 115.8 metres northeast of that junction.

ROYAL PARADE – Southeast and south sides

- i) From its junction with B4260 Wilton Road to a point 60.7 metres west of its junction with the tangent point of the western kerblines of St. Mary's Street.
- ii) From its junction with St. Mary's Street to a point 49.0 metres west of its junction with the western kerblines of St. Mary's Street.

RYEFIELD ROAD – Both sides

- i) From its junction with B4260 Gloucester Road for a distance of 7.0 metres in a northerly direction.

SMALLBROOK ROAD – East side

- i) From a point 176.3 metres north of its junction with Gloucester Road to its junction with Station Approach and the Ashburton Industrial Estate Road.

- ii) From its junction with Gloucester Road to a point 96.8 metres north of that junction.

SMALLBROOK ROAD – West side

- i) From its junction with Gloucester Road for a distance of 40.0 metres in a northerly direction.
- ii) From a point 166.3 metres north of its junction with Gloucester Road to its junction with Cantilupe Road.

STATION STREET – North side

- i) For its entire length from its junction with the B4234 Brookend Street to its junction with Station Approach and the Ashburton Industrial Estate Road.

STATION STREET – South side

- i) From its junction with B4234 Broad Street to a point 40.2 metres east of that junction.
- ii) From its junction with the tangent point of the western kerblines of Henry Street for a distance of 7.0 metres in a westerly direction.
- iii) From its junction with the tangent point of the eastern kerblines of Henry Street for a distance of 7.0 metres in an easterly direction.
- iv) From a point 51.0 metres east of its junction with the tangent point of the eastern kerblines of Henry Street to its junction with Cantilupe Road.

TRENCHARD STREET – Both sides

- i) For its entire length from its junction with Greytree Road and Homs Road to its junction with Edde Cross Street.

B4260 WILTON ROAD – North and northwest sides

- i) From its junction with Edde Cross Street to a point 76.0 metres southwest of its junction with the tangent point of the western kerblines of the eastern junction of Wye Street.
- ii) From its western junction with Wye Street to a point 224.0 metres east of that junction.

B4260 WILTON ROAD – South and southeast sides

- i) From its junction with Edde Cross Street and High Street to its junction with the western junction of Wye Street.

SCHEDULE 5

No Waiting 9am to 6pm.

B4260 GLOUCESTER ROAD – North side

- i) From a point 50.0 metres east of its junction with the tangent point of the eastern kerblines of Cantilupe Road to a point 10 metres west of its junction with the tangent point of the western kerblines of Smallbrook Road.
- ii) From a point 10.0 metres east of its junction with the tangent point of the eastern kerblines of Smallbrook Road to a point 10.0 metres west of its junction with the tangent point of the western kerblines of Ryefield Road.

EDDE CROSS STREET – East side

- i) From a point 19.0 metres south of its junction with the tangent point of the southern kerblines of New Street to a point 59.7 metres south of that junction.

SMALLBROOK ROAD – West side

- i) From a point 65.0 metres north of its junction with Gloucester Road to a point 90.0 metres north of that junction.
- ii) From a point 119.6 metres north of its junction with Gloucester Road to a point 166.3 metres north of that junction.

SCHEDULE 6

Waiting limited to 30 minutes (Mon to Sat)(9am to 6pm)(no return to any parking place within the same street within 1 hour.)

B4234 BROAD STREET – Southeast side

- i) From a point 34.3 metres southwest of its junction with the southern kerblines of Kyrle Street to a point 64.3 metres southwest of that junction.

B4234 BROAD STREET – Northwest side

- i) From a point 69.4 metres southwest of its junction with the southern kerblines of Kyrle Street to a point 105.9 metres southwest of that junction.
- ii) From a point 51.2 metres southwest of its junction with the southern kerblines of Kyrle Street to a point 64.3 metres southwest of that junction.

B4260 GLOUCESTER ROAD – North side

- i) From a point 10.7 metres west of its junction with the tangent point of the western kerblines of Henry Street to a point 31.6 metres west of that junction.
- ii) From a point 42.0 metres west of its junction with the tangent point of the western kerblines of Henry Street to a point 73.0 metres west of that junction.

B4260 GLOUCESTER ROAD – South side

- i) From a point 22.5 metres west of its junction with the centre line of Chase Road to a point 46.3 metres west of that junction.
- ii) From a point 96.0 metres west of its junction with the centre line of Chase Road to a point 130.0 metres west of that junction.
- iii) From a point 169.3 metres west of its junction with the centre line of Chase Road to a point 196.0 metres west of that junction.

SCHEDULE 7

Waiting limited to 30 minutes (Mon to Sat) (9am to 6pm,) (no return to any parking place within the same street within 1 hour) (Hackney Carriage Rank 10pm to 3am).

- i) B4234 BROAD STREET - Southeast side
From a point 18.5 metres southwest of its junction with the southern kerblines of Kyrle Street to a point 34.3 metres southwest of that junction.

SCHEDULE 8

Waiting limited to 1 hour (Mon to Sat)(9am to 6pm) (no return to any parking place within the same street within 1 hour) (except Parking Permit Holders as Schedule 15)

HENRY STREET – East side

- i) From a point 44.0 metres south of its junction with Station Street to a point 100.5 metres south of that junction.
- ii) From a point 112.0 metres south of its junction with Station Street to a point 165.7 metres south of that junction.

STATION STREET – South side

- i) From a point 40.2 metres east of its junction with B4234 Broad Street to a point 7.0 metres west of its junction with the tangent point of the western kerblines of Henry Street.
- ii) From a point 7.0 metres east of its junction with the tangent point of the eastern kerblines of Henry Street to a point 51.0 metres east of that junction.

SCHEDULE 9

Waiting limited to 2 hours (Mon to Sat)(9am to 6 pm.) (no return to any parking place within the same street within 2 hours) (except Parking Permit Holders as Schedule 15).

CHURCH STREET – Northwest side

- i) From a point 59.0 metres south of its junction with the southern kerbline of High Street to a point 111.2 metres south of that junction.
- ii) From a point 135.0 metres south of its junction with the southern kerbline of High Street to a point 141.4 metres southwest of that junction.
- iii) From a point 148.5 metres south of its junction with the southern kerbline of High Street to a point 200.0 metres south of that junction.

EDDE CROSS STREET – East side

- i) From a point 53.2 metres north of its junction with the tangent point of the northern kerbline of New Street to a point 69.7 metres north of that junction.
- ii) From a point 13.5 metres north of its junction with the tangent point of the northern kerbline of New Street to a point 32.3 metres north of that junction.

B4260 GLOUCESTER ROAD – South side

- i) From a point 66.8 metres east of its junction with the centre line of Chase Road to its junction with the centreline of Smallbrook Road

KYRLE STREET – South side

- i) From a point 15.5 metres east of its junction with Edde Cross Street to a point 67.0 metres east of that junction.

OLD GLOUCESTER ROAD – North side

- i) From a point 39.0 metres west of its junction with Chase Road to a point 115.5 metres east of its junction with B4234 High Street and Copse Cross Street.

OLD GLOUCESTER ROAD – South side

- i) From a point 89.0 metres west of its junction with Chase Road to a point 115.5 metres east of its junction with the B4234 High Street and Copse Cross Street.

OLD MAID'S WALK – South side

- i) From a point 15.0 metres west of its junction with the B4234 Walford Road to a point 26.5 metres west of that junction.
- ii) From a point 41.0 metres west of its junction with the B4234 Walford Road to a point 53.5 metres west of that junction.
- iii) From a point 63.8 metres west of its junction with the B4234 Walford Road to a point 109.0 metres west of that junction.

ROYAL PARADE – North side

- i) From a point 115.8 metres northeast of its junction with the B4260 Wilton Road to its junction with St. Mary's Street.

ROYAL PARADE – Northwest side

- i) From a point 20.1 metres northeast of its junction with the B4260 Wilton Road to a point 80.0 metres north of that junction.

ROYAL PARADE – South side

- i) From a point 49.0 metres northwest of the tangent point of the western kerbline of St. Mary's Street to a point 60.7 metres west of that junction.

ST. MARY'S STREET – Northwest side

- i) From its junction with the tangent point of the northern kerbline of Royal Parade to a point 31.9 metres south of its junction with the southern kerbline of the B4260 High Street.

SMALLBROOK ROAD – East side

- i) From a point 96.8 metres north of its junction with Gloucester Road to a point 176.3 metres north of that junction.

SMALLBROOK ROAD – West side

- i) From a point 40.0 metres north of its junction with Gloucester Road to a point 65.0 metres north of that junction.
ii) From a point 90.0 metres north of its junction with Gloucester Road to a point 119.6 metres north of that point.

SCHEDULE 10

Waiting limited to 4 hours (Mon to Sat)(9am to 6pm) (no return to any parking place within the same street within 4 hours) (except Parking Permit Holders as stated in Schedule 15)

B4260 WILTON ROAD – Northwest side

- i) From a point 76.0 metres southwest of its junction with the tangent point of the western kerblines of the eastern junction of Wye Street to a point 165.8 metres south west of that point.

SCHEDULE 11

Disabled Permit Holders only (limited to 2 hours) (no return to any parking place within the same street within 2 hours).

B4234 BROAD STREET – Northeast side

- i) From a point 32.3 metres southwest of its junction with the southern kerblines of Kyrle Street to a point 51.2 metres southwest of that junction.

B4234 BROAD STREET – Southwest side *East ?*

- i) From a point 69.4 metres southwest of its junction with the southern kerblines of Kyrle Street to a point 82.7 metres southwest of that junction.

B4260 GLOUCESTER ROAD – North side

- i) From a point 42.6 metres west of its junction with the tangent point of the western kerblines of Hill Street to a point 54.6 metres west of that junction.

SCHEDULE 12

Loading only (Mon to Sat)(6am to 6pm) (limited to 15 minutes for cars and other vehicles and, no limit for Goods Vehicles,) (no return to any loading bay within the same street within 1 hour.)

B4234 BROAD STREET - Northeast side

- i) From a point 18.5 metres southwest of its junction with the southern kerblines of Kyrle Street to a point 32.3 metres southwest of that junction.

B4234 BROAD STREET – Southwest side

- i) From a point 82.7 metres southwest of its junction with the southern kerblines of Kyrle Street to a point 100.6 metres southwest of that junction.

B4260 GLOUCESTER ROAD – North side

- i) From a point 26.5 metres west of its junction with the tangent point of the western kerblines of Hill Street to a point 36.8 metres west of that junction.

B4260 GLOUCESTER ROAD – South side

- i) From a point 68.0 metres west of its junction with the centre line of Chase Road to a point 89.0 metres west of that junction.
ii) From a point 136.6 metres west of its junction with the centre line of Chase Road to a point 157.3 metres west of that junction.

B4234 MARKET PLACE – East side

- i) From a point 35.0 metres south of the tangent point between the southwestern kerblines of New Street and the northeastern kerblines of Broad Street to a point 61.6 metres south of that point.

B4234 MARKET PLACE – West side

- i) From a point 24.0 metres south of the tangent point between the southwestern kerblines of New Street and the northeastern kerblines of Broad Street to a point 67.7 metres south of that point.

SCHEDULE 13

Loading only (Mon to Sat) (6am to 6pm) (limited to 15 minutes for cars and other vehicles, no limit for Goods Vehicles) (no return within 1 hour.) (Hackney Carriage Stand 10pm to 3am with a maximum of two Hackney Carriage Vehicles to wait at any one time).

B4260 HIGH STREET – North side

- iii) From a point 10.5 metres east of the eastern kerblines of Church Street to a point 35.5 metres east of the eastern kerblines of Church Street.

SCHEDULE 14

Hackney Carriage Stand. (all day) (maximum of two Hackney Carriage Vehicles allowed to wait at any one time)

B4260 GLOUCESTER ROAD - South side

- i) From a point 196.0 metres west of its junction with the centre line of Chase Road to a point 206.0 metres west of that junction.

SCHEDULE 15

<u>Street where resident eligible for a Parking Permit (as appropriate)</u>	<u>Streets in which vehicles may wait (as appropriate)</u>
ZONE RA	ZONE RA
Royal Parade St. Mary's Street Wilton Road (between both junctions with Wye Street) Wye Street	Royal Parade St. Mary's Street Wilton Road Wye Street
ZONE RB	ZONE RB
Alton Street (numbers 1 to 3) Church Street Cope Cross Street Old Gloucester Road Walford Road (The Toll Cottage) Old Maid's Walk	Alton Street Church Street Old Gloucester Road Old Maid's Walk
ZONE RC	ZONE RC
Edde Cross Street Kyrle Street New Street	Edde Cross Street Kyrle Street New Street

ZONE RD	ZONE RD
Cantilupe Road Crofts Court Crofts Lane Gloucester Road (21 to 26 Oriel House, Beatrice House, Linton Rise) Henry Street Hill Street Smallbrook Gardens Station Street Goodrich Court	Cantilupe Road Gloucester Road (east of Chase Road) Henry Street Hill Street Smallbrook Road Station Street

17
18
19
20

